

NW LOOP

Amrap

Kings

AKW

Amrap - to
condemn
w 3/4
acres

60TH

→ 50' wide new
→ need 50' more

Recorp

COUNTY LINE

Bern Co

Recorp

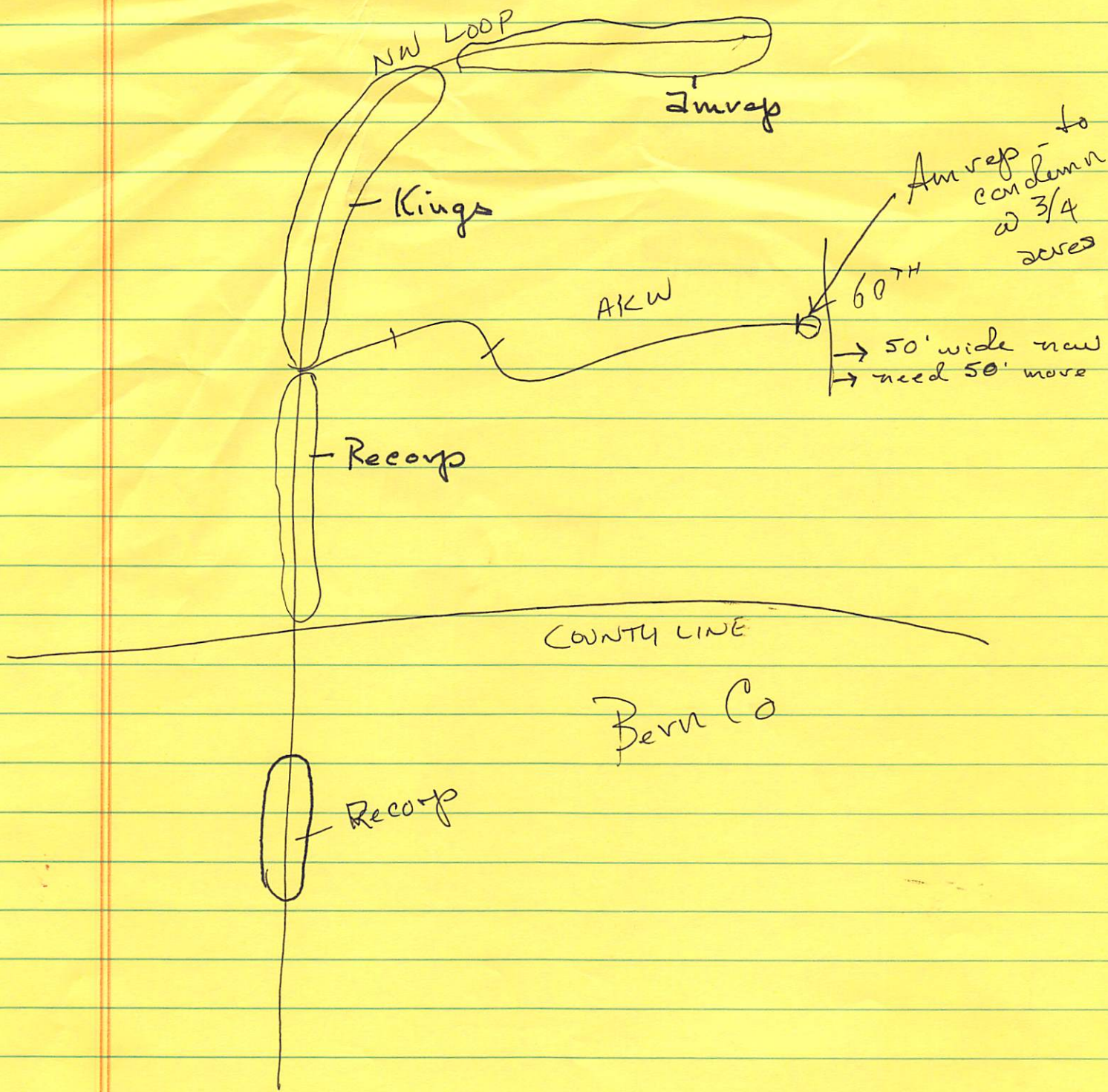

2

1-2000

5-00-15

22

County of Sandoval

WARRANTY DEED

AMREP SOUTHWEST, INC., a New Mexico Corporation hereinafter referred to as the Grantor, for valuable consideration paid, grants to the **County of Sandoval**, a political subdivision of the State of New Mexico, whose address is P.O. Box 40, Bernalillo, New Mexico, 87004, hereinafter referred to as the Grantee for the following described real estate in **Sandoval County**, New Mexico, identified as **Take 21-1 to 32-1-Q, Project SP-7543(205)**, and which is more specifically described as:

See Exhibit A attached here to and incorporated herein by reference ("the Property") with warranty covenants.

The property shall be used solely for the public roadway and utility right-of-way. Until the access controlled roadway is constructed by Grantee, its successors or assigns on the Property, Grantor, its successors or assigns reserves the right to access through over and across the Property, and the right to use the Property so long as Grantor's activities on the property do not adversely affect Grantee's construction of the roadway.

Grantee and its successors and assigns shall allow grantor and its successors and assigns to have access at the designated access points onto the roadway indicated on Project drawings SP-7543(205) as prepared by Avid Engineering from the real property owned by the Grantor adjacent to the roadway.

This grant is subject to:

- Reservations of patent, restrictive covenants, easements, and rights-of way of record.
- Taxes for the year of 2009 and subsequent years.
- Reservations of all oil, gas, mineral, geothermal, and water rights.
- ANY SPECIFIC FILED DOCUMENTS THAT COLOR THE TITLE.

All covenants and conditions contained herein shall be binding on the parties and their successors and assigns and shall run with the land.

(See Reverse Side)

AMREP SOUTHWEST INC.

By: _____
President

ACKNOWLEDGEMENT

STATE OF NEW MEXICO)
)SS
COUNTY OF)

This instrument was acknowledged before me this _____ day of _____, 2010, by
_____, President of AMREP SOUTHWEST, INC.
on behalf of said corporation.

Notary Public

My Commission Expires: _____

**SP-7543(205)
Northwest Loop Road**

**Amrep Southwest, Inc.
24-1-A**

A certain parcel of land lying and being situate within Section 7, Township 13 North, Range 2 East, Sandoval County, State of New Mexico and being a portion of that parcel of land entitled PROPOSED SCHOOL SITE, within Block 60, Unit Twenty-Six Rio Rancho Estates, as said PROPOSED SCHOOL SITE parcel is shown and designated on the Plat entitled "BLOCKS 52 THRU 73, MULTIPLE TRACTS "CC" AND "DD", UNIT TWENTY-SIX RIO RANCHO ESTATES" as filed for record in the office of the county clerk of Sandoval County, State of New Mexico on March 12, 1970 in Volume 2, Folio 23, and being more particularly described by New Mexico State Plane Grid (Central Zone) bearings and ground distances as follows:

BEGINNING at a point, a found 1/4" rebar, 201.45 feet to the left of, northerly and opposite Survey Centerline POT Station 1643+74.90 of NMP SP-7543(205), County of Sandoval, State of New Mexico, said point being on the northerly right-of-way line of NMP SP-7543(205) and being the northeast corner of said PROPOSED SCHOOL SITE;

thence leaving said northerly right-of-way line of NMP SP-7543(205) and following along an easterly boundary line of the property of the Grantor, S00°00'22"E a distance of 226.32 feet to a point;

thence continuing along the said easterly boundary line of the property of the Grantor, S30°00'36"E a distance of 144.58 feet to a point on the southerly right-of-way line of NMP SP-7543(205);

thence following along said southerly right-of-way line of NMP SP-7543(205), N89°56'50"W a distance of 703.31 feet to a point on the westerly boundary line of the property of the Grantor;

thence following along the said westerly boundary line of the property of the Grantor, N59°59'36"E a distance of 622.17 feet to a point on the northerly right-of-way line of NMP SP-7543(205);

thence N59°59'36"E along the said northerly right-of-way line of NMP SP-7543(205) a distance of 80.01 feet to a point;

thence S89°17'08"E a distance of 22.91 feet to the point and place of beginning

Containing 119,519 square feet (2.7438 acres) more or less.

SP-7543(205)
Northwest Loop Road

Amrep Southwest, Inc.
26-1-C

A certain parcel of land lying and being situate within Section 8, Township 13 North, Range 2 East, Sandoval County, State of New Mexico and being a portion of that parcel of land entitled ARROYO, Unit Twenty-Six Rio Rancho Estates, as said parcel is shown and designated on the Plat entitled "BLOCKS 36 THRU 51, TRACTS "C" & "D", COMMERCIAL TRACTS "E" & "F" MULTIPLE TRACTS "AA" & "BB" UNIT TWENTY-SIX RIO RANCHO ESTATES", filed in the office of the county clerk of Sandoval County, State of New Mexico on March 12, 1970 in Volume 2, Folio 22, and being more particularly described by New Mexico State Plane Grid (Central Zone) bearings and ground distances as follows:

BEGINNING at a point 150.00 feet to the left of, northerly and opposite Survey Centerline POC Station 1697+94.24 of NMP SP-7543(205), County of Sandoval, State of New Mexico, said point being on the present (1993) westerly right-of-way line of Beryl Road N.E. (50' right-of-way) and on the northerly right-of-way line of NMP SP-7543(205), from whence the northeast corner of said Section 8, Township 13 North, Range 2 East, a brass cap set in concrete bears N33°51'08"E a distance of 4374.38 feet;

thence leaving said northerly right-of-way line of NMP SP-7543(205) and following along said westerly right-of-way line of Beryl Road N.E., S04°00'33"E a distance of 16.33 feet to a point of curvature;

thence southwesterly on a 20°50'05" curve (radius= 275.00 feet, chord= S12°20'06"W a distance of 154.78 feet) thru an arc of 32°41'20" to the right a distance of 156.90 feet;

thence leaving said westerly right-of-way line of Beryl Road N.E. and following the easterly lot line of Lot 132, Block 44, Rio Rancho Estates, Unit Twenty-Six, N49°59'07"W a distance of 260.83 feet to a point on the northerly right-of-way line of NMP SP-7543(205);

thence S89°56'50"E along the said northerly line of NMP SP-7543(205) a distance of 231.68 feet to the point and place of beginning.

Containing 20,913 square feet (0.4801 acres) more or less.

SP-7543(205)
Northwest Loop Road

Amrep Southwest, Inc.
26-1-D

A certain parcel of land lying and being situate within Section 8, Township 13 North, Range 2 East, Sandoval County, State of New Mexico and being a portion of that parcel of land entitled ARROYO PANTADELEON, Unit Twenty-Six Rio Rancho Estates, as said parcel is shown and designated on the Plat entitled "BLOCKS 36 THRU 51, TRACTS "C" & "D", COMMERCIAL TRACTS "E" & "F" MULTIPLE TRACTS "AA" & "BB" UNIT TWENTY-SIX RIO RANCHO ESTATES", filed in the office of the county clerk of Sandoval County, State of New Mexico on March 12, 1970 in Volume 2, Folio 22, and being more particularly described by New Mexico State Plane Grid (Central Zone) bearings and ground distances as follows:

BEGINNING at a point 150.00 feet to the left of, northerly and opposite Survey Centerline POC Station 1711+34.17 of NMP SP-7543(205), County of Sandoval, State of New Mexico, said point being on the northerly right-of-way line of NMP SP-7543(205), from whence the northeast corner of said Section 8, Township 13 North, Range 2 East, a brass cap set in concrete bears N16°47'42"E a distance of 3795.97 feet;

thence leaving said northerly right-of-way line of NMP SP-7543(203) and following along a westerly boundary line of Tract D, Rio Rancho Estates, Unit Twenty-Six, S09°59'54"W a distance of 304.58 feet to a point on the southerly right-of-way line of NMP SP-7543(203);

thence following along said southerly right-of-way line of NMP SP-7543(203), N89°56'50"W a distance of 846.09 feet to a point on the easterly lot line of Lot 1, Block 36, Rio Rancho Estates Unit Twenty-Six;

thence leaving said southerly right-of-way line of NMP SP-7543(203) and following along said easterly lot line of Lot 1, N29°58'18"W a distance of 39.64 feet to a point;

thence following along the northerly lot line of said Lot 1, N71°37'32"W a distance of 406.62 feet to a point on the present (1993) easterly right-of-way line of Beryl Road N.E.;

thence northerly along the easterly right-of-way line of Beryl Road N.E. on a 17°37'46" curve (radius= 325.00 feet, chord= N07°10'31"E a distance of 126.08 feet) through an arc of 22°22'10" to the left a distance of 126.89 feet to a point of tangency;

thence continuing along said easterly right-of-way line of Beryl Road N.E., N04°00'33"W a distance of 12.78 feet to a point on the northerly right-of-way line of NMP SP-7543(203);

thence leaving said easterly right-of-way line of Beryl Road N.E. and following along said northerly right-of-way line of NMP SP-7543(203), S89°56'50"E a distance of 1289.81 feet to the point and place of beginning.

Containing 343,519 square feet (7.8861 acres) more or less.

SP-7543(205)
Northwest Loop Road

Amrep Southwest, Inc.
26-1-E

A certain parcel of land lying and being situated within Section 8, Township 13 North, Range 2 East, Sandoval County, State of New Mexico and being a portion of Tract D, Unit Twenty-Six Rio Rancho Estates, as shown and designated on the Plat entitled "BLOCKS 36 THRU 51, TRACTS 'C' & 'D', COMMERCIAL TRACTS 'E' & 'F' MULTIPLE TRACTS 'AA' & 'BB' UNIT TWENTY-SIX RIO RANCHO ESTATES", filed in the office of the county clerk of Sandoval County, State of New Mexico on March 12, 1970 in Volume 2, Folio 22, and being more particularly described by New Mexico State Plane Grid (Central Zone) bearings and ground distances as follows:

BEGINNING at a point 150.00 feet to the left of, northerly and opposite Survey Centerline POT Station 1711+34.17 of NMP SP-7543(205), County of Sandoval, State of New Mexico, said point being on a westerly boundary line of said Tract D, from whence the northeast corner of said Section 8, Township 13 North, Range 2 East, a brass cap set in concrete bears N16°47'42"E a distance of 3795.97 feet;

thence following along said northerly right-of-way line of NMP SP-7543(203), S89°56'50"E a distance of 959.94 feet to a point on the easterly boundary line of said Tract D and on the eastern line of said Section 8;

thence leaving said northerly right-of-way line of NMP SP-7543(203) and following said easterly boundary line of Tract D and said eastern line of Section 8, S02°09'24"W a distance of 300.20 feet to a point on the southerly right-of-way line of NMP SP-7543(203);

thence following along said southerly right-of-way line of NMP SP-7543(203), N89°56'50"W a distance of 1001.53 feet to a point on a westerly boundary line of said Tract D;

thence following along said westerly Boundary line of Tract D, N09°56'54"E a distance of 304.58 feet to the point and place of beginning.

Containing 294,221 square feet (6.7544 acres) more or less.

SP-7543(205)

Amrep Southwest, Inc.
21-1

All of that certain tract of land lying and being situate within Section 12, Township 13 North, Range 1 East, Sandoval County, State of New Mexico and being all of Lot 22, Block 129, Unit Twenty-Six Rio Rancho Estates, as said Lot is shown and designated on the Plat entitled "A PORTION OF BLOCKS 73, 78 & 81, BLOCKS 129 THRU 141, TRACT "I", UNIT TWENTY-SIX RIO RANCHO ESTATES" as filed for record in the office of the county clerk of Sandoval County, State of New Mexico on February 8, 1971 in Volume 2, Folio 45, and containing 22,643 square feet (0.5198 acre), more or less.

The northwest corner of the parcel herein described lies 158.97 feet to the left of, northerly and opposite survey centerline POT station 1558+06.36 of NMP SP-7543(205).

SP-7543(205)

**Amrep Southwest, Inc.
21-1-A**

All of that certain tract of land lying and being situate within Section 12, Township 13 North, Range 1 East, Sandoval County, State of New Mexico and being all of Lot 21, Block 129, Unit Twenty-Six Rio Rancho Estates, as said Lot is shown and designated on the Plat entitled "A PORTION OF BLOCKS 73, 78 & 81, BLOCKS 129 THRU 141, TRACT "I", UNIT TWENTY-SIX RIO RANCHO ESTATES" as filed for record in the office of the county clerk of Sandoval County, State of New Mexico on February 8, 1971 in Volume 2, Folio 45, and containing 22,719 square feet (0.5216 acre), more or less.

The northwest corner of the parcel herein described lies 78.98 feet to the left of, northerly and opposite survey centerline POT station 1558+05.52 of NMP SP-7543(205).

SP-7543(205)

**Amrep Southwest, Inc.
21-1-B**

All of that certain tract of land lying and being situate within Section 12, Township 13 North, Range 1 East, Sandoval County, State of New Mexico and being all of Lot 20, Block 129, Unit Twenty-Six Rio Rancho Estates, as said Lot is shown and designated on the Plat entitled "A PORTION OF BLOCKS 73, 78 & 81, BLOCKS 129 THRU 141, TRACT "I", UNIT TWENTY-SIX RIO RANCHO ESTATES" as filed for record in the office of the county clerk of Sandoval County, State of New Mexico on February 8, 1971 in Volume 2, Folio 45, and containing 22,792 square feet (0.5232 acre), more or less.

The northwest corner of the parcel herein described lies 1.02 feet to the right of, southerly and opposite survey centerline POT station 1558+04.68 of NMP SP-7543(205).

SP-7543(205)

**Amrep Southwest, Inc.
21-1-C**

All of that certain tract of land lying and being situate within Section 12, Township 13 North, Range 1 East, Sandoval County, State of New Mexico and being all of Lot 146, Block 78, Unit Twenty-Six Rio Rancho Estates, as said Lot is shown and designated on the Plat entitled "A PORTION OF BLOCKS 73, 78 & 81, BLOCKS 129 THRU 141, TRACT "I", UNIT TWENTY-SIX RIO RANCHO ESTATES" as filed for record in the office of the county clerk of Sandoval County, State of New Mexico on February 8, 1971 in Volume 2, Folio 45, and containing 21,639 square feet (0.4968 acre), more or less.

The northwest corner of the parcel herein described lies 129.51 feet to the left of, northerly and opposite survey centerline POT station 1561+38.94 of NMP SP-7543(205).

805

SP-7543(205)

**Amrep Southwest, Inc.
21-1-D**

All of that certain tract of land lying and being situate within Section 12, Township 13 North, Range 1 East, Sandoval County, State of New Mexico and being all of Lot 145, Block 78, Unit Twenty-Six Rio Rancho Estates, as said Lot is shown and designated on the Plat entitled "A PORTION OF BLOCKS 73, 78 & 81, BLOCKS 129 THRU 141, TRACT "I", UNIT TWENTY-SIX RIO RANCHO ESTATES" as filed for record in the office of the county clerk of Sandoval County, State of New Mexico on February 8, 1971 in Volume 2, Folio 45, and containing 21,784 square feet (0.5001 acre), more or less.

The northwest corner of the parcel herein described lies 129.60 feet to the left of, northerly and opposite survey centerline POT station 1562+18.94 of NMP SP-7543(205).

SP-7543(205)

**Amrep Southwest, Inc.
21-1-E**

All of that certain tract of land lying and being situate within Section 12, Township 13 North, Range 1 East, Sandoval County, State of New Mexico and being all of Lot 144, Block 78, Unit Twenty-Six Rio Rancho Estates, as said Lot is shown and designated on the Plat entitled "A PORTION OF BLOCKS 73, 78 & 81, BLOCKS 129 THRU 141, TRACT "I", UNIT TWENTY-SIX RIO RANCHO ESTATES" as filed for record in the office of the county clerk of Sandoval County, State of New Mexico on February 8, 1971 in Volume 2, Folio 45, and containing 21,784 square feet (0.5001 acre), more or less.

The northwest corner of the parcel herein described lies 129.68 feet to the left of, northerly and opposite survey centerline POT station 1562+98.94 of NMP SP-7543(205).

807

SP-7543(205)

**Amrep Southwest, Inc.
21-1-F**

All of that certain tract of land lying and being situate within Section 12, Township 13 North, Range 1 East, Sandoval County, State of New Mexico and being all of Lot 143, Block 78, Unit Twenty-Six Rio Rancho Estates, as said Lot is shown and designated on the Plat entitled "A PORTION OF BLOCKS 73, 78 & 81, BLOCKS 129 THRU 141, TRACT "I", UNIT TWENTY-SIX RIO RANCHO ESTATES" as filed for record in the office of the county clerk of Sandoval County, State of New Mexico on February 8, 1971 in Volume 2, Folio 45, and containing 21,785 square feet (0.5001 acre), more or less.

The northwest corner of the parcel herein described lies 129.77 feet to the left of, northerly and opposite survey centerline POT station 1563+78.94 of NMP SP-7543(205).

SP-7543(205)

**Amrep Southwest, Inc.
21-1-G**

All of that certain tract of land lying and being situate within Section 12, Township 13 North, Range 1 East, Sandoval County, State of New Mexico and being all of Lot 142, Block 78, Unit Twenty-Six Rio Rancho Estates, as said Lot is shown and designated on the Plat entitled "A PORTION OF BLOCKS 73, 78 & 81, BLOCKS 129 THRU 141, TRACT "I", UNIT TWENTY-SIX RIO RANCHO ESTATES" as filed for record in the office of the county clerk of Sandoval County, State of New Mexico on February 8, 1971 in Volume 2, Folio 45, and containing 46,883 square feet (1.0763 acre), more or less.

The northwest corner of the parcel herein described lies 129.86 feet to the left of, northerly and opposite survey centerline POT station 1564+58.96 of NMP SP-7543(205).

809

SP-7543(205)

**Amrep Southwest, Inc.
21-1-H**

All of that certain tract of land lying and being situate within Section 12, Township 13 North, Range 1 East, Sandoval County, State of New Mexico and being all of Lot 141, Block 78, Unit Twenty-Six Rio Rancho Estates, as said Lot is shown and designated on the Plat entitled "A PORTION OF BLOCKS 73, 78 & 81, BLOCKS 129 THRU 141, TRACT "I", UNIT TWENTY-SIX RIO RANCHO ESTATES" as filed for record in the office of the county clerk of Sandoval County, State of New Mexico on February 8, 1971 in Volume 2, Folio 45, and containing 30,515 square feet (0.7005 acre), more or less.

The northwest corner of the parcel herein described lies 188.73 feet to the left of, northerly and opposite survey centerline POT station 1565+39.05 of NMP SP-7543(205).

SP-7543(205)

**Amrep Southwest, Inc.
21-1-I**

All of that certain tract of land lying and being situate within Section 12, Township 13 North, Range 1 East, Sandoval County, State of New Mexico and being all of Lot 85, Block 78, Unit Twenty-Six Rio Rancho Estates, as said Lot is shown and designated on the Plat entitled "A PORTION OF BLOCKS 73, 78 & 81, BLOCKS 129 THRU 141, TRACT "I", UNIT TWENTY-SIX RIO RANCHO ESTATES" as filed for record in the office of the county clerk of Sandoval County, State of New Mexico on February 8, 1971 in Volume 2, Folio 45, and containing 36,738 square feet (0.8434 acre), more or less.

The northwest corner of the parcel herein described lies 382.27 feet to the left of, northerly and opposite survey centerline POT station 1566+78.54 of NMP SP-7543(205).

SP-7543(205)

**Amrep Southwest, Inc.
21-1-J**

All of that certain tract of land lying and being situate within Section 12, Township 13 North, Range 1 East, Sandoval County, State of New Mexico and being all of Lot 84, Block 78, Unit Twenty-Six Rio Rancho Estates, as said Lot is shown and designated on the Plat entitled "A PORTION OF BLOCKS 73, 78 & 81, BLOCKS 129 THRU 141, TRACT "I", UNIT TWENTY-SIX RIO RANCHO ESTATES" as filed for record in the office of the county clerk of Sandoval County, State of New Mexico on February 8, 1971 in Volume 2, Folio 45, and containing 40,849 square feet (0.9378 acre), more or less.

The northeast corner of the parcel herein described lies 129.96 feet to the left of, northerly and opposite survey centerline POT station 1569+09.70 of NMP SP-7543(205).

SP-7543(205)

**Amrep Southwest, Inc.
21-1-K**

All of that certain tract of land lying and being situate within Section 12, Township 13 North, Range 1 East, Sandoval County, State of New Mexico and being all of Lot 83, Block 78, Unit Twenty-Six Rio Rancho Estates, as said Lot is shown and designated on the Plat entitled "A PORTION OF BLOCKS 73, 78 & 81, BLOCKS 129 THRU 141, TRACT "I", UNIT TWENTY-SIX RIO RANCHO ESTATES" as filed for record in the office of the county clerk of Sandoval County, State of New Mexico on February 8, 1971 in Volume 2, Folio 45, and containing 21,760 square feet (0.4995 acre), more or less.

The northwest corner of the parcel herein described lies 129.96 feet to the left of, northerly and opposite survey centerline POT station 1569+09.70 of NMP SP-7543(205).

SP-7543(205)

**Amrep Southwest, Inc.
21-1-L**

All of that certain tract of land lying and being situate within Section 12, Township 13 North, Range 1 East, Sandoval County, State of New Mexico and being all of Lot 82, Block 78, Unit Twenty-Six Rio Rancho Estates, as said Lot is shown and designated on the Plat entitled "A PORTION OF BLOCKS 73, 78 & 81, BLOCKS 129 THRU 141, TRACT "I", UNIT TWENTY-SIX RIO RANCHO ESTATES" as filed for record in the office of the county clerk of Sandoval County, State of New Mexico on February 8, 1971 in Volume 2, Folio 45, and containing 21,761 square feet (0.4996 acre), more or less.

The northwest corner of the parcel herein described lies 130.04 feet to the left of, northerly and opposite survey centerline POT station 1569+89.70 of NMP SP-7543(205).

SP-7543(205)

**Amrep Southwest, Inc.
21-1-M**

All of that certain tract of land lying and being situate within Section 12, Township 13 North, Range 1 East, Sandoval County, State of New Mexico and being all of Lot 81, Block 78, Unit Twenty-Six Rio Rancho Estates, as said Lot is shown and designated on the Plat entitled "A PORTION OF BLOCKS 73, 78 & 81, BLOCKS 129 THRU 141, TRACT "I", UNIT TWENTY-SIX RIO RANCHO ESTATES" as filed for record in the office of the county clerk of Sandoval County, State of New Mexico on February 8, 1971 in Volume 2, Folio 45, and containing 21,765 square feet (0.4997 acre), more or less.

The northwest corner of the parcel herein described lies 130.11 feet to the left of, northerly and opposite survey centerline POT station 1570+69.69 of NMP SP-7543(205).

SP-7543(205)

**Amrep Southwest, Inc.
21-1-N**

All of that certain tract of land lying and being situate within Section 12, Township 13 North, Range 1 East, Sandoval County, State of New Mexico and being all of Lot 80, Block 78, Unit Twenty-Six Rio Rancho Estates, as said Lot is shown and designated on the Plat entitled "A PORTION OF BLOCKS 73, 78 & 81, BLOCKS 129 THRU 141, TRACT "I", UNIT TWENTY-SIX RIO RANCHO ESTATES" as filed for record in the office of the county clerk of Sandoval County, State of New Mexico on February 8, 1971 in Volume 2, Folio 45, and containing 21,768 square feet (0.4997 acre), more or less.

The northwest corner of the parcel herein described lies 130.19 feet to the left of, northerly and opposite survey centerline POT station 1571+49.69 of NMP SP-7543(205).

SP-7543(205)

**Amrep Southwest, Inc.
21-1-O**

All of that certain tract of land lying and being situate within Section 12, Township 13 North, Range 1 East, Sandoval County, State of New Mexico and being all of Lot 79, Block 78, Unit Twenty-Six Rio Rancho Estates, as said Lot is shown and designated on the Plat entitled "A PORTION OF BLOCKS 73, 78 & 81, BLOCKS 129 THRU 141, TRACT "I", UNIT TWENTY-SIX RIO RANCHO ESTATES" as filed for record in the office of the county clerk of Sandoval County, State of New Mexico on February 8, 1971 in Volume 2, Folio 45, and containing 21,767 square feet (0.4997 acre), more or less.

The northwest corner of the parcel herein described lies 130.27 feet to the left of, northerly and opposite survey centerline POT station 1572+29.69 of NMP SP-7543(205).

SP-7543(205)

**Amrep Southwest, Inc.
21-1-P**

All of that certain tract of land lying and being situate within Section 12, Township 13 North, Range 1 East, Sandoval County, State of New Mexico and being all of Lot 78, Block 78, Unit Twenty-Six Rio Rancho Estates, as said Lot is shown and designated on the Plat entitled "A PORTION OF BLOCKS 73, 78 & 81, BLOCKS 129 THRU 141, TRACT "I", UNIT TWENTY-SIX RIO RANCHO ESTATES" as filed for record in the office of the county clerk of Sandoval County, State of New Mexico on February 8, 1971 in Volume 2, Folio 45, and containing 21,773 square feet (0.4998 acre), more or less.

The northwest corner of the parcel herein described lies 130.34 feet to the left of, northerly and opposite survey centerline POT station 1573+09.67 of NMP SP-7543(205).

SP-7543(205)

**Amrep Southwest, Inc.
21-1-Q**

All of that certain tract of land lying and being situate within Section 12, Township 13 North, Range 1 East, Sandoval County, State of New Mexico and being all of Lot 77, Block 78, Unit Twenty-Six Rio Rancho Estates, as said Lot is shown and designated on the Plat entitled "A PORTION OF BLOCKS 73, 78 & 81, BLOCKS 129 THRU 141, TRACT "I", UNIT TWENTY-SIX RIO RANCHO ESTATES" as filed for record in the office of the county clerk of Sandoval County, State of New Mexico on February 8, 1971 in Volume 2, Folio 45, and containing 21,774 square feet (0.4999 acre), more or less.

The northwest corner of the parcel herein described lies 130.42 feet to the left of, northerly and opposite survey centerline POT station 1573+89.67 of NMP SP-7543(205).

SP-7543(205)

**Amrep Southwest, Inc.
21-1-R**

All of that certain tract of land lying and being situate within Section 12, Township 13 North, Range 1 East, Sandoval County, State of New Mexico and being all of Lot 76, Block 78, Unit Twenty-Six Rio Rancho Estates, as said Lot is shown and designated on the Plat entitled "A PORTION OF BLOCKS 73, 78 & 81, BLOCKS 129 THRU 141, TRACT "I", UNIT TWENTY-SIX RIO RANCHO ESTATES" as filed for record in the office of the county clerk of Sandoval County, State of New Mexico on February 8, 1971 in Volume 2, Folio 45, and containing 21,779 square feet (0.5000 acre), more or less.

The northwest corner of the parcel herein described lies 130.50 feet to the left of, northerly and opposite survey centerline POT station 1574+69.66 of NMP SP-7543(205).

SP-7543(205)

**Amrep Southwest, Inc.
21-1-S**

All of that certain tract of land lying and being situate within Section 12, Township 13 North, Range 1 East, Sandoval County, State of New Mexico and being all of Lot 75, Block 78, Unit Twenty-Six Rio Rancho Estates, as said Lot is shown and designated on the Plat entitled "A PORTION OF BLOCKS 73, 78 & 81, BLOCKS 129 THRU 141, TRACT "I", UNIT TWENTY-SIX RIO RANCHO ESTATES" as filed for record in the office of the county clerk of Sandoval County, State of New Mexico on February 8, 1971 in Volume 2, Folio 45, and containing 25,387 square feet (0.5828 acre), more or less.

The northwest corner of the parcel herein described lies 130.57 feet to the left of, northerly and opposite survey centerline POT station 1575+49.66 of NMP SP-7543(205).

SP-7543(205)

**Amrep Southwest, Inc.
21-1-T**

All of that certain tract of land lying and being situate within Section 12, Township 13 North, Range 1 East, Sandoval County, State of New Mexico and being all of Lot 74, Block 78, Unit Twenty-Six Rio Rancho Estates, as said Lot is shown and designated on the Plat entitled "A PORTION OF BLOCKS 73, 78 & 81, BLOCKS 129 THRU 141, TRACT "I", UNIT TWENTY-SIX RIO RANCHO ESTATES" as filed for record in the office of the county clerk of Sandoval County, State of New Mexico on February 8, 1971 in Volume 2, Folio 45, and containing 21,653 square feet (0.4971 acre), more or less.

The northwest corner of the parcel herein described lies 130.66 feet to the left of, northerly and opposite survey centerline POT station 1576+42.91 of NMP SP-7543(205).

SP-7543(205)

**Amrep Southwest, Inc.
21-1-U**

All of that certain tract of land lying and being situate within Section 12, Township 13 North, Range 1 East, Sandoval County, State of New Mexico and being all of Lot 73, Block 78, Unit Twenty-Six Rio Rancho Estates, as said Lot is shown and designated on the Plat entitled "A PORTION OF BLOCKS 73, 78 & 81, BLOCKS 129 THRU 141, TRACT "I", UNIT TWENTY-SIX RIO RANCHO ESTATES" as filed for record in the office of the county clerk of Sandoval County, State of New Mexico on February 8, 1971 in Volume 2, Folio 45, and containing 21,780 square feet (0.5000 acre), more or less.

The northwest corner of the parcel herein described lies 50.62 feet to the left of, northerly and opposite survey centerline POT station 1576+42.98 of NMP SP-7543(205).

SP-7543(205)

**Amrep Southwest, Inc.
21-1-V**

All of that certain tract of land lying and being situate within Section 12, Township 13 North, Range 1 East, Sandoval County, State of New Mexico and being all of Lot 72, Block 78, Unit Twenty-Six Rio Rancho Estates, as said Lot is shown and designated on the Plat entitled "A PORTION OF BLOCKS 73, 78 & 81, BLOCKS 129 THRU 141, TRACT "I", UNIT TWENTY-SIX RIO RANCHO ESTATES" as filed for record in the office of the county clerk of Sandoval County, State of New Mexico on February 8, 1971 in Volume 2, Folio 45, and containing 21,777 square feet (0.4999 acre), more or less.

The northwest corner of the parcel herein described lies 29.41 feet to the right of, southerly and opposite survey centerline POT station 1576+43.06 of NMP SP-7543(205).

SP-7543(205)

**Amrep Southwest, Inc.
21-1-W**

All of that certain tract of land lying and being situate within Section 12, Township 13 North, Range 1 East, Sandoval County, State of New Mexico and being all of Lot 71, Block 78, Unit Twenty-Six Rio Rancho Estates, as said Lot is shown and designated on the Plat entitled "A PORTION OF BLOCKS 73, 78 & 81, BLOCKS 129 THRU 141, TRACT "I", UNIT TWENTY-SIX RIO RANCHO ESTATES" as filed for record in the office of the county clerk of Sandoval County, State of New Mexico on February 8, 1971 in Volume 2, Folio 45, and containing 21,769 square feet (0.4997 acre), more or less.

The southeast corner of the parcel herein described lies 189.26 feet to the right of, southerly and opposite survey centerline POT station 1579+15.16 of NMP SP-7543(205).

SP-7543(205)

**Amrep Southwest, Inc.
21-1-X**

All of that certain tract of land lying and being situate within Section 12, Township 13 North, Range 1 East, Sandoval County, State of New Mexico and being all of Lot 135, Block 131, Unit Twenty-Six Rio Rancho Estates, as said Lot is shown and designated on the Plat entitled "A PORTION OF BLOCKS 73, 78 & 81, BLOCKS 129 THRU 141, TRACT "I", UNIT TWENTY-SIX RIO RANCHO ESTATES" as filed for record in the office of the county clerk of Sandoval County, State of New Mexico on February 8, 1971 in Volume 2, Folio 45, and containing 21,658 square feet (0.4972 acre), more or less.

The northeast corner of the parcel herein described lies 131.19 feet to the left of, northerly and opposite survey centerline POT station 1582+37.52 of NMP SP-7543(205).

SP-7543(205)

**Amrep Southwest, Inc.
21-1-Y**

All of that certain tract of land lying and being situate within Section 12, Township 13 North, Range 1 East, Sandoval County, State of New Mexico and being all of Lot 134, Block 131, Unit Twenty-Six Rio Rancho Estates, as said Lot is shown and designated on the Plat entitled "A PORTION OF BLOCKS 73, 78 & 81, BLOCKS 129 THRU 141, TRACT "I", UNIT TWENTY-SIX RIO RANCHO ESTATES" as filed for record in the office of the county clerk of Sandoval County, State of New Mexico on February 8, 1971 in Volume 2, Folio 45, and containing 21,794 square feet (0.5003 acre), more or less.

The northeast corner of the parcel herein described lies 51.19 feet to the left of, northerly and opposite survey centerline POT station 1582+37.56 of NMP SP-7543(205).

SP-7543(205)

**Amrep Southwest, Inc.
21-1-Z**

All of that certain tract of land lying and being situate within Section 12, Township 13 North, Range 1 East, Sandoval County, State of New Mexico and being all of Lot 133, Block 131, Unit Twenty-Six Rio Rancho Estates, as said Lot is shown and designated on the Plat entitled "A PORTION OF BLOCKS 73, 78 & 81, BLOCKS 129 THRU 141, TRACT "I", UNIT TWENTY-SIX RIO RANCHO ESTATES" as filed for record in the office of the county clerk of Sandoval County, State of New Mexico on February 8, 1971 in Volume 2, Folio 45, and containing 21,797 square feet (0.5003 acre), more or less.

The northeast corner of the parcel herein described lies 28.81 feet to the right of, southerly and opposite survey centerline POT station 1582+37.60 of NMP SP-7543(205).

SP-7543(205)

Amrep Southwest, Inc.
21-3

All of that certain tract of land lying and being situate within Section 12, Township 13 North, Range 1 East, Sandoval County, State of New Mexico and being all of Lot 132, Block 131, Unit Twenty-Six Rio Rancho Estates, as said Lot is shown and designated on the Plat entitled "A PORTION OF BLOCKS 73, 78 & 81, BLOCKS 129 THRU 141, TRACT "I", UNIT TWENTY-SIX RIO RANCHO ESTATES" as filed for record in the office of the county clerk of Sandoval County, State of New Mexico on February 8, 1971 in Volume 2, Folio 45, and containing 21,829 square feet (0.5011 acre), more or less.

The southwest corner of the parcel herein described lies 189.03 feet to the right of, southerly and opposite survey centerline POT station 1579+65.43 of NMP SP-7543(205).

829

SP-7543(205)

**Amrep Southwest, Inc.
21-3-A**

All of that certain tract of land lying and being situate within Section 12, Township 13 North, Range 1 East, Sandoval County, State of New Mexico and being all of Lot 1, Block 131, Unit Twenty-Six Rio Rancho Estates, as said Lot is shown and designated on the Plat entitled "A PORTION OF BLOCKS 73, 78 & 81, BLOCKS 129 THRU 141, TRACT "I", UNIT TWENTY-SIX RIO RANCHO ESTATES" as filed for record in the office of the county clerk of Sandoval County, State of New Mexico on February 8, 1971 in Volume 2, Folio 45, and containing 21,637 square feet (0.4967 acre), more or less.

The northwest corner of the parcel herein described lies 131.19 feet to the left of, northerly and opposite survey centerline POT station 1582+37.52 of NMP SP-7543(205).

SP-7543(205)

**Amrep Southwest, Inc.
21-3-B**

All of that certain tract of land lying and being situate within Section 12, Township 13 North, Range 1 East, Sandoval County, State of New Mexico and being all of Lot 2, Block 131, Unit Twenty-Six Rio Rancho Estates, as said Lot is shown and designated on the Plat entitled "A PORTION OF BLOCKS 73, 78 & 81, BLOCKS 129 THRU 141, TRACT "I", UNIT TWENTY-SIX RIO RANCHO ESTATES" as filed for record in the office of the county clerk of Sandoval County, State of New Mexico on February 8, 1971 in Volume 2, Folio 45, and containing 21,774square feet (0.4999 acre), more or less.

The northwest corner of the parcel herein described lies 51.19 feet to the left of, northerly and opposite survey centerline POT station 1582+37.56 of NMP SP-7543(205).

831

SP-7543(205)

Amrep Southwest, Inc.
21-3-C

All of that certain tract of land lying and being situate within Section 12, Township 13 North, Range 1 East, Sandoval County, State of New Mexico and being all of Lot 3, Block 131, Unit Twenty-Six Rio Rancho Estates, as said Lot is shown and designated on the Plat entitled "A PORTION OF BLOCKS 73, 78 & 81, BLOCKS 129 THRU 141, TRACT "I", UNIT TWENTY-SIX RIO RANCHO ESTATES" as filed for record in the office of the county clerk of Sandoval County, State of New Mexico on February 8, 1971 in Volume 2, Folio 45, and containing 21,777 square feet (0.4999 acre), more or less.

The northwest corner of the parcel herein described lies 28.81 feet to the right of, southerly and opposite survey centerline POT station 1582+37.60 of NMP SP-7543(205).

SP-7543(205)

**Amrep Southwest, Inc.
21-3-D**

All of that certain tract of land lying and being situate within Section 12, Township 13 North, Range 1 East, Sandoval County, State of New Mexico and being all of Lot 4, Block 131, Unit Twenty-Six Rio Rancho Estates, as said Lot is shown and designated on the Plat entitled "A PORTION OF BLOCKS 73, 78 & 81, BLOCKS 129 THRU 141, TRACT "I", UNIT TWENTY-SIX RIO RANCHO ESTATES" as filed for record in the office of the county clerk of Sandoval County, State of New Mexico on February 8, 1971 in Volume 2, Folio 45, and containing 21,778 square feet (0.5000 acre), more or less.

The northwest corner of the parcel herein described lies 108.81 feet to the right of, southerly and opposite survey centerline POT station 1582+37.63 of NMP SP-7543(205).

SP-7543(205)

Amrep Southwest, Inc.
22-3

All of that certain tract of land lying and being situate within Section 12, Township 13 North, Range 1 East, Sandoval County, State of New Mexico and being all of Lot 55, Block 132, Unit Twenty-Six Rio Rancho Estates, as said Lot is shown and designated on the Plat entitled "A PORTION OF BLOCKS 73, 78 & 81, BLOCKS 129 THRU 141, TRACT "I", UNIT TWENTY-SIX RIO RANCHO ESTATES" as filed for record in the office of the county clerk of Sandoval County, State of New Mexico on February 8, 1971 in Volume 2, Folio 45, and containing 21,789 square feet (0.5002 acre), more or less.

The northwest corner of the parcel herein described lies 131.70 feet to the left of, northerly and opposite survey centerline POT station 1588+31.90 of NMP SP-7543(205).

834

SP-7543(205)

**Amrep Southwest, Inc.
22-3-A**

All of that certain tract of land lying and being situate within Section 12, Township 13 North, Range 1 East, Sandoval County, State of New Mexico and being all of Lot 54, Block 132, Unit Twenty-Six Rio Rancho Estates, as said Lot is shown and designated on the Plat entitled "A PORTION OF BLOCKS 73, 78 & 81, BLOCKS 129 THRU 141, TRACT "I", UNIT TWENTY-SIX RIO RANCHO ESTATES" as filed for record in the office of the county clerk of Sandoval County, State of New Mexico on February 8, 1971 in Volume 2, Folio 45, and containing 21,790 square feet (0.5002 acre), more or less.

The northwest corner of the parcel herein described lies 131.76 feet to the left of, northerly and opposite survey centerline POT station 1589+11.90 of NMP SP-7543(205).

835

SP-7543(205)

**Amrep Southwest, Inc.
22-3-B**

All of that certain tract of land lying and being situate within Section 12, Township 13 North, Range 1 East, Sandoval County, State of New Mexico and being all of Lot 53, Block 132, Unit Twenty-Six Rio Rancho Estates, as said Lot is shown and designated on the Plat entitled "A PORTION OF BLOCKS 73, 78 & 81, BLOCKS 129 THRU 141, TRACT "I", UNIT TWENTY-SIX RIO RANCHO ESTATES" as filed for record in the office of the county clerk of Sandoval County, State of New Mexico on February 8, 1971 in Volume 2, Folio 45, and containing 21,789 square feet (0.5002 acre), more or less.

The northwest corner of the parcel herein described lies 131.83 feet to the left of, northerly and opposite survey centerline POT station 1589+91.90 of NMP SP-7543(205).

SP-7543(205)

**Amrep Southwest, Inc.
22-3-C**

All of that certain tract of land lying and being situate within Section 12, Township 13 North, Range 1 East, Sandoval County, State of New Mexico and being all of Lot 48, Block 132, Unit Twenty-Six Rio Rancho Estates, as said Lot is shown and designated on the Plat entitled "A PORTION OF BLOCKS 73, 78 & 81, BLOCKS 129 THRU 141, TRACT "I", UNIT TWENTY-SIX RIO RANCHO ESTATES" as filed for record in the office of the county clerk of Sandoval County, State of New Mexico on February 8, 1971 in Volume 2, Folio 45, and containing 21,787 square feet (0.5002 acre), more or less.

The northwest corner of the parcel herein described lies 132.15 feet to the left of, northerly and opposite survey centerline POT station 1593+91.90 of NMP SP-7543(205).

SP-7543(205)

**Amrep Southwest, Inc.
22-3-D**

All of that certain tract of land lying and being situate within Section 12, Township 13 North, Range 1 East, Sandoval County, State of New Mexico and being all of Lot 47, Block 132, Unit Twenty-Six Rio Rancho Estates, as said Lot is shown and designated on the Plat entitled "A PORTION OF BLOCKS 73, 78 & 81, BLOCKS 129 THRU 141, TRACT "I", UNIT TWENTY-SIX RIO RANCHO ESTATES" as filed for record in the office of the county clerk of Sandoval County, State of New Mexico on February 8, 1971 in Volume 2, Folio 45, and containing 21,787 square feet (0.5002 acre), more or less.

The northwest corner of the parcel herein described lies 132.22 feet to the left of, northerly and opposite survey centerline POT station 1594+71.90 of NMP SP-7543(205).

SP-7543(205)

**Amrep Southwest, Inc.
22-3-E**

All of that certain tract of land lying and being situate within Section 12, Township 13 North, Range 1 East, Sandoval County, State of New Mexico and being all of Lot 46, Block 132, Unit Twenty-Six Rio Rancho Estates, as said Lot is shown and designated on the Plat entitled "A PORTION OF BLOCKS 73, 78 & 81, BLOCKS 129 THRU 141, TRACT "I", UNIT TWENTY-SIX RIO RANCHO ESTATES" as filed for record in the office of the county clerk of Sandoval County, State of New Mexico on February 8, 1971 in Volume 2, Folio 45, and containing 21,787 square feet (0.5002 acre), more or less.

The northwest corner of the parcel herein described lies 132.28 feet to the left of, northerly and opposite survey centerline POT station 1595+51.90 of NMP SP-7543(205).

SP-7543(205)

**Amrep Southwest, Inc.
22-3-F**

All of that certain tract of land lying and being situate within Section 12, Township 13 North, Range 1 East, Sandoval County, State of New Mexico and being all of Lot 45, Block 132, Unit Twenty-Six Rio Rancho Estates, as said Lot is shown and designated on the Plat entitled "A PORTION OF BLOCKS 73, 78 & 81, BLOCKS 129 THRU 141, TRACT "I", UNIT TWENTY-SIX RIO RANCHO ESTATES" as filed for record in the office of the county clerk of Sandoval County, State of New Mexico on February 8, 1971 in Volume 2, Folio 45, and containing 21,786 square feet (0.5001 acre), more or less.

The northwest corner of the parcel herein described lies 132.35 feet to the left of, northerly and opposite survey centerline POT station 1596+31.90 of NMP SP-7543(205).

SP-7543(205)

**Amrep Southwest, Inc.
22-3-G**

All of that certain tract of land lying and being situate within Section 12, Township 13 North, Range 1 East, Sandoval County, State of New Mexico and being all of Lot 44, Block 132, Unit Twenty-Six Rio Rancho Estates, as said Lot is shown and designated on the Plat entitled "A PORTION OF BLOCKS 73, 78 & 81, BLOCKS 129 THRU 141, TRACT "I", UNIT TWENTY-SIX RIO RANCHO ESTATES" as filed for record in the office of the county clerk of Sandoval County, State of New Mexico on February 8, 1971 in Volume 2, Folio 45, and containing 21,785 square feet (0.5001 acre), more or less.

The northwest corner of the parcel herein described lies 132.41 feet to the left of, northerly and opposite survey centerline POT station 1597+11.90 of NMP SP-7543(205).

841

SP-7543(205)

**Amrep Southwest, Inc.
22-3-H**

All of that certain tract of land lying and being situate within Section 12, Township 13 North, Range 1 East, Sandoval County, State of New Mexico and being all of Lot 41, Block 132, Unit Twenty-Six Rio Rancho Estates, as said Lot is shown and designated on the Plat entitled "A PORTION OF BLOCKS 73, 78 & 81, BLOCKS 129 THRU 141, TRACT "I", UNIT TWENTY-SIX RIO RANCHO ESTATES" as filed for record in the office of the county clerk of Sandoval County, State of New Mexico on February 8, 1971 in Volume 2, Folio 45, and containing 21,785 square feet (0.5001 acre), more or less.

The northwest corner of the parcel herein described lies 132.60 feet to the left of, northerly and opposite survey centerline POT station 1599+51.89 of NMP SP-7543(205).

SP-7543(205)

**Amrep Southwest, Inc.
22-3-I**

All of that certain tract of land lying and being situate within Section 12, Township 13 North, Range 1 East, Sandoval County, State of New Mexico and being all of Lot 40, Block 132, Unit Twenty-Six Rio Rancho Estates, as said Lot is shown and designated on the Plat entitled "A PORTION OF BLOCKS 73, 78 & 81, BLOCKS 129 THRU 141, TRACT "I", UNIT TWENTY-SIX RIO RANCHO ESTATES" as filed for record in the office of the county clerk of Sandoval County, State of New Mexico on February 8, 1971 in Volume 2, Folio 45, and containing 21,785 square feet (0.5001 acre), more or less.

The northwest corner of the parcel herein described lies 132.67 feet to the left of, northerly and opposite survey centerline POT station 1600+31.89 of NMP SP-7543(205).

SP-7543(205)

**Amrep Southwest, Inc.
22-3-J**

All of that certain tract of land lying and being situate within Section 12, Township 13 North, Range 1 East, Sandoval County, State of New Mexico and being all of Lot 39, Block 132, Unit Twenty-Six Rio Rancho Estates, as said Lot is shown and designated on the Plat entitled "A PORTION OF BLOCKS 73, 78 & 81, BLOCKS 129 THRU 141, TRACT "I", UNIT TWENTY-SIX RIO RANCHO ESTATES" as filed for record in the office of the county clerk of Sandoval County, State of New Mexico on February 8, 1971 in Volume 2, Folio 45, and containing 21,784 square feet (0.5001 acre), more or less.

The northwest corner of the parcel herein described lies 132.73 feet to the left of, northerly and opposite survey centerline POT station 1601 + 11.89 of NMP SP-7543(205).

SP-7543(205)

**Amrep Southwest, Inc.
22-3-K**

All of that certain tract of land lying and being situate within Section 12, Township 13 North, Range 1 East, Sandoval County, State of New Mexico and being all of Lot 37, Block 132, Unit Twenty-Six Rio Rancho Estates, as said Lot is shown and designated on the Plat entitled "A PORTION OF BLOCKS 73, 78 & 81, BLOCKS 129 THRU 141, TRACT "I", UNIT TWENTY-SIX RIO RANCHO ESTATES" as filed for record in the office of the county clerk of Sandoval County, State of New Mexico on February 8, 1971 in Volume 2, Folio 45, and containing 21,784 square feet (0.5001 acre), more or less.

The northwest corner of the parcel herein described lies 132.86 feet to the left of, northerly and opposite survey centerline POT station 1602+71.89 of NMP SP-7543(205).

SP-7543(205)

**Amrep Southwest, Inc.
22-3-L**

All of that certain tract of land lying and being situate within Section 12, Township 13 North, Range 1 East, Sandoval County, State of New Mexico and being all of Lot 35, Block 132, Unit Twenty-Six Rio Rancho Estates, as said Lot is shown and designated on the Plat entitled "A PORTION OF BLOCKS 73, 78 & 81, BLOCKS 129 THRU 141, TRACT "I", UNIT TWENTY-SIX RIO RANCHO ESTATES" as filed for record in the office of the county clerk of Sandoval County, State of New Mexico on February 8, 1971 in Volume 2, Folio 45, and containing 21,783 square feet (0.5001 acre), more or less.

The northwest corner of the parcel herein described lies 132.99 feet to the left of, northerly and opposite survey centerline POT station 1604+31.89 of NMP SP-7543(205).

SP-7543(205)

**Amrep Southwest, Inc.
22-3-M**

All of that certain tract of land lying and being situate within Section 7, Township 13 North, Range 2 East, Sandoval County, State of New Mexico and being all of Lot 67, Block 73, Unit Twenty-Six Rio Rancho Estates, as said Lot is shown and designated on the Plat entitled "A PORTION OF BLOCKS 73, 78 & 81, BLOCKS 129 THRU 141, TRACT "I", UNIT TWENTY-SIX RIO RANCHO ESTATES" as filed for record in the office of the county clerk of Sandoval County, State of New Mexico on March 12, 1970 in Volume 2, Folio 45, and containing 29,338 square feet (0.6735 acre), more or less.

The northwest corner of the parcel herein described lies 128.36 feet to the left of, northerly and opposite survey centerline POT station 1610+92.02 of NMP SP-7543(205).

SP-7543(205)

**Amrep Southwest, Inc.
23-5**

All of that certain tract of land lying and being situate within Section 7, Township 13 North, Range 2 East, Sandoval County, State of New Mexico and being all of Lot 79, Block 73, Unit Twenty-Six Rio Rancho Estates, as said Lot is shown and designated on the Plat entitled "BLOCKS 52 THRU 73, MULTIPLE TRACTS "CC" AND "DD", UNIT TWENTY-SIX RIO RANCHO ESTATES" as filed for record in the office of the county clerk of Sandoval County, State of New Mexico on March 12, 1970 in Volume 2, Folio 23, and containing 32,916 square feet (0.7557 acre), more or less.

The northeast corner of the parcel herein described lies 28.26 feet to the left of, northerly and opposite survey centerline POT station 1615+39.30 of NMP SP-7543(205).

848

SP-7543(205)

**Amrep Southwest, Inc.
23-5-A**

All of that certain tract of land lying and being situate within Section 7, Township 13 North, Range 2 East, Sandoval County, State of New Mexico and being all of Lot 78, Block 73, Unit Twenty-Six Rio Rancho Estates, as said Lot is shown and designated on the Plat entitled "BLOCKS 52 THRU 73, MULTIPLE TRACTS "CC" AND "DD", UNIT TWENTY-SIX RIO RANCHO ESTATES" as filed for record in the office of the county clerk of Sandoval County, State of New Mexico on March 12, 1970 in Volume 2, Folio 23, and containing 30,286 square feet (0.6953 acre), more or less.

The northwest corner of the parcel herein described lies 28.26 feet to the left of, northerly and opposite survey centerline POT station 1615+39.30 of NMP SP-7543(205).

SP-7543(205)

Amrep Southwest, Inc.
23-5-B

All of that certain tract of land lying and being situate within Section 7, Township 13 North, Range 2 East, Sandoval County, State of New Mexico and being all of Lot 77, Block 73, Unit Twenty-Six Rio Rancho Estates, as said Lot is shown and designated on the Plat entitled "BLOCKS 52 THRU 73, MULTIPLE TRACTS "CC" AND "DD", UNIT TWENTY-SIX RIO RANCHO ESTATES" as filed for record in the office of the county clerk of Sandoval County, State of New Mexico on March 12, 1970 in Volume 2, Folio 23, and containing 28,524 square feet (0.6548 acre), more or less.

The northwest corner of the parcel herein described lies 82.21 feet to the left of, northerly and opposite survey centerline POT station 1616+32.57 of NMP SP-7543(205).

850

SP-7543(205)

**Amrep Southwest, Inc.
23-5-C**

All of that certain tract of land lying and being situate within Section 7, Township 13 North, Range 2 East, Sandoval County, State of New Mexico and being all of Lot 76, Block 73, Unit Twenty-Six Rio Rancho Estates, as said Lot is shown and designated on the Plat entitled "BLOCKS 52 THRU 73, MULTIPLE TRACTS "CC" AND "DD", UNIT TWENTY-SIX RIO RANCHO ESTATES" as filed for record in the office of the county clerk of Sandoval County, State of New Mexico on March 12, 1970 in Volume 2, Folio 23, and containing 28,210 square feet (0.6476 acre), more or less.

The northwest corner of the parcel herein described lies 134.97 feet to the left of, northerly and opposite survey centerline POT station 1617+23.79 of NMP SP-7543(205).

SP-7543(205)

**Amrep Southwest, Inc.
23-5-D**

All of that certain tract of land lying and being situate within Section 7, Township 13 North, Range 2 East, Sandoval County, State of New Mexico and being all of Lot 74, Block 73, Unit Twenty-Six Rio Rancho Estates, as said Lot is shown and designated on the Plat entitled "BLOCKS 52 THRU 73, MULTIPLE TRACTS "CC" AND "DD", UNIT TWENTY-SIX RIO RANCHO ESTATES" as filed for record in the office of the county clerk of Sandoval County, State of New Mexico on March 12, 1970 in Volume 2, Folio 23, and containing 21,787 square feet (0.5002 acre), more or less.

The northeast corner of the parcel herein described lies 385.27 feet to the left of, northerly and opposite survey centerline POT station 1616+12.85 of NMP SP-7543(205).

852

SP-7543(205)

**Amrep Southwest, Inc.
23-5-E**

All of that certain tract of land lying and being situate within Section 7, Township 13 North, Range 2 East, Sandoval County, State of New Mexico and being all of Lot 14, Block 66, Unit Twenty-Six Rio Rancho Estates, as said Lot is shown and designated on the Plat entitled "BLOCKS 52 THRU 73, MULTIPLE TRACTS "CC" AND "DD", UNIT TWENTY-SIX RIO RANCHO ESTATES" as filed for record in the office of the county clerk of Sandoval County, State of New Mexico on March 12, 1970 in Volume 2, Folio 23, and containing 21,633 square feet (0.4966 acre), more or less.

The northwest corner of the parcel herein described lies 167.76 feet to the left of, northerly and opposite survey centerline POT station 1622+03.51 of NMP SP-7543(205).

853

SP-7543(205)

**Amrep Southwest, Inc.
23-5-F**

All of that certain tract of land lying and being situate within Section 7, Township 13 North, Range 2 East, Sandoval County, State of New Mexico and being all of Lot 15, Block 65, Unit Twenty-Six Rio Rancho Estates, as said Lot is shown and designated on the Plat entitled "BLOCKS 52 THRU 73, MULTIPLE TRACTS "CC" AND "DD", UNIT TWENTY-SIX RIO RANCHO ESTATES" as filed for record in the office of the county clerk of Sandoval County, State of New Mexico on March 12, 1970 in Volume 2, Folio 23, and containing 24,037 square feet (0.5518 acre), more or less.

The northwest corner of the parcel herein described lies 171.75 feet to the right of, southerly and opposite survey centerline POT station 1619+79.70 of NMP SP-7543(205).

SP-7543(205)

**Amrep Southwest, Inc.
23-5-G**

All of that certain tract of land lying and being situate within Section 7, Township 13 North, Range 2 East, Sandoval County, State of New Mexico and being all of Lot 16, Block 65, Unit Twenty-Six Rio Rancho Estates, as said Lot is shown and designated on the Plat entitled "BLOCKS 52 THRU 73, MULTIPLE TRACTS "CC" AND "DD", UNIT TWENTY-SIX RIO RANCHO ESTATES" as filed for record in the office of the county clerk of Sandoval County, State of New Mexico on March 12, 1970 in Volume 2, Folio 23, and containing 21,791 square feet (0.5002 acre), more or less.

The southwest corner of the parcel herein described lies 358.38 feet to the right of, southerly and opposite survey centerline POT station 1621+97.42 of NMP SP-7543(205).

SP-7543(205)

**Amrep Southwest, Inc.
23-S-H**

All of that certain tract of land lying and being situate within Section 7, Township 13 North, Range 2 East, Sandoval County, State of New Mexico and being all of Lot 17, Block 65, Unit Twenty-Six Rio Rancho Estates, as said Lot is shown and designated on the Plat entitled "BLOCKS 52 THRU 73, MULTIPLE TRACTS "CC" AND "DD", UNIT TWENTY-SIX RIO RANCHO ESTATES" as filed for record in the office of the county clerk of Sandoval County, State of New Mexico on March 12, 1970 in Volume 2, Folio 23, and containing 21,789 square feet (0.5002 acre), more or less.

The southwest corner of the parcel herein described lies 318.31 feet to the right of, southerly and opposite survey centerline POT station 1622+66.66 of NMP SP-7543(205).

856

SP-7543(205)

**Amrep Southwest, Inc.
23-5-I**

All of that certain tract of land lying and being situate within Section 7, Township 13 North, Range 2 East, Sandoval County, State of New Mexico and being all of Lot 18, Block 65, Unit Twenty-Six Rio Rancho Estates, as said Lot is shown and designated on the Plat entitled "BLOCKS 52 THRU 73, MULTIPLE TRACTS "CC" AND "DD", UNIT TWENTY-SIX RIO RANCHO ESTATES" as filed for record in the office of the county clerk of Sandoval County, State of New Mexico on March 12, 1970 in Volume 2, Folio 23, and containing 21,787 square feet (0.5002 acre), more or less.

The southwest corner of the parcel herein described lies 278.24 feet to the right of, southerly and opposite survey centerline POT station 1623+35.90 of NMP SP-7543(205).

SP-7543(205)

**Amrep Southwest, Inc.
23-5-J**

All of that certain tract of land lying and being situate within Section 7, Township 13 North, Range 2 East, Sandoval County, State of New Mexico and being all of Lot 35, Block 65, Unit Twenty-Six Rio Rancho Estates, as said Lot is shown and designated on the Plat entitled "BLOCKS 52 THRU 73, MULTIPLE TRACTS "CC" AND "DD", UNIT TWENTY-SIX RIO RANCHO ESTATES" as filed for record in the office of the county clerk of Sandoval County, State of New Mexico on March 12, 1970 in Volume 2, Folio 23, and containing 21,771 square feet (0.4998 acre), more or less.

The southwest corner of the parcel herein described lies 273.49 feet to the right of, southerly and opposite survey centerline POT station 1628+87.48 of NMP SP-7543(205).

858.

SP-7543(205)

**Amrep Southwest, Inc.
23-5-K**

All of that certain tract of land lying and being situate within Section 7, Township 13 North, Range 2 East, Sandoval County, State of New Mexico and being all of Lot 28, Block 65, Unit Twenty-Six Rio Rancho Estates, as said Lot is shown and designated on the Plat entitled "BLOCKS 52 THRU 73, MULTIPLE TRACTS "CC" AND "DD", UNIT TWENTY-SIX RIO RANCHO ESTATES" as filed for record in the office of the county clerk of Sandoval County, State of New Mexico on March 12, 1970 in Volume 2, Folio 23, and containing 21,776 square feet (0.4999 acre), more or less.

The northeast corner of the parcel herein described lies 398.13 feet to the left of, northerly and opposite survey centerline POT station 1629+61.26 of NMP SP-7543(205).

SP-7543(205)

**Amrep Southwest, Inc.
23-5-L**

All of that certain tract of land lying and being situate within Section 7, Township 13 North, Range 2 East, Sandoval County, State of New Mexico and being all of Lot 20, Block 59, Unit Twenty-Six Rio Rancho Estates, as said Lot is shown and designated on the Plat entitled "BLOCKS 52 THRU 73, MULTIPLE TRACTS "CC" AND "DD", UNIT TWENTY-SIX RIO RANCHO ESTATES" as filed for record in the office of the county clerk of Sandoval County, State of New Mexico on March 12, 1970 in Volume 2, Folio 23, and containing 21,641 square feet (0.4968 acre), more or less.

The northwest corner of the parcel herein described lies 235.39 feet to the left of, northerly and opposite survey centerline POT station 1632+23.33 of NMP SP-7543(205).

860

SP-7543(205)

**Amrep Southwest, Inc.
23-5-M**

All of that certain tract of land lying and being situate within Section 7, Township 13 North, Range 2 East, Sandoval County, State of New Mexico and being all of Lot 19, Block 59, Unit Twenty-Six Rio Rancho Estates, as said Lot is shown and designated on the Plat entitled "BLOCKS 52 THRU 73, MULTIPLE TRACTS "CC" AND "DD", UNIT TWENTY-SIX RIO RANCHO ESTATES" as filed for record in the office of the county clerk of Sandoval County, State of New Mexico on March 12, 1970 in Volume 2, Folio 23, and containing 21,775 square feet (0.4999 acre), more or less.

The northwest corner of the parcel herein described lies 275.47 feet to the left of, northerly and opposite survey centerline POT station 1632+92.57 of NMP SP-7543(205).

SP-7543(205)

**Amrep Southwest, Inc.
24-1**

All of that certain tract of land lying and being situate within Section 7, Township 13 North, Range 2 East, Sandoval County, State of New Mexico and being all of Lot 8, Block 60, Unit Twenty-Six Rio Rancho Estates, as said Lot is shown and designated on the Plat entitled "BLOCKS 52 THRU 73, MULTIPLE TRACTS "CC" AND "DD", UNIT TWENTY-SIX RIO RANCHO ESTATES" as filed for record in the office of the county clerk of Sandoval County, State of New Mexico on March 12, 1970 in Volume 2, Folio 23, and containing 21,791 square feet (0.5003 acre), more or less.

The northeast corner of the parcel herein described lies 277.18 feet to the left of, northerly and opposite survey centerline POT station 1639+38.60 of NMP SP-7543(205).

SP-7543(205)

**Amrep Southwest, Inc.
24-1-B**

All of that certain tract of land lying and being situate within Section 7, Township 13 North, Range 2 East, Sandoval County, State of New Mexico and being all of Lot 17, Block 60, Unit Twenty-Six Rio Rancho Estates, as said Lot is shown and designated on the Plat entitled "BLOCKS 52 THRU 73, MULTIPLE TRACTS "CC" AND "DD", UNIT TWENTY-SIX RIO RANCHO ESTATES" as filed for record in the office of the county clerk of Sandoval County, State of New Mexico on March 12, 1970 in Volume 2, Folio 23, and containing 26,850 square feet (0.6164 acre), more or less.

The northwest corner of the parcel herein described lies 228.53 feet to the left of, northerly and opposite survey centerline POT station 1643+74.87 of NMP SP-7543(205).

863

SP-7543(205)

**Amrep Southwest, Inc.
24-1-C**

All of that certain tract of land lying and being situate within Section 7, Township 13 North, Range 2 East, Sandoval County, State of New Mexico and being all of Lot 18, Block 60, Unit Twenty-Six Rio Rancho Estates, as said Lot is shown and designated on the Plat entitled "BLOCKS 52 THRU 73, MULTIPLE TRACTS "CC" AND "DD", UNIT TWENTY-SIX RIO RANCHO ESTATES" as filed for record in the office of the county clerk of Sandoval County, State of New Mexico on March 12, 1970 in Volume 2, Folio 23, and containing 39,074 square feet (0.8970 acre), more or less.

The northeast corner of the parcel herein described lies 135.72 feet to the left of, northerly and opposite survey centerline POT station 1646+47.18 of NMP SP-7543(205).

SP-7543(205)

**Amrep Southwest, Inc.
24-1-D**

All of that certain tract of land lying and being situate within Section 7, Township 13 North, Range 2 East, Sandoval County, State of New Mexico and being all of Lot 30, Block 55, Unit Twenty-Six Rio Rancho Estates, as said Lot is shown and designated on the Plat entitled "BLOCKS 52 THRU 73, MULTIPLE TRACTS "CC" AND "DD", UNIT TWENTY-SIX RIO RANCHO ESTATES" as filed for record in the office of the county clerk of Sandoval County, State of New Mexico on March 12, 1970 in Volume 2, Folio 23, and containing 26,542 square feet (0.6093 acre), more or less.

The southwest corner of the parcel herein described lies 94.72 feet to the right of, southerly and opposite survey centerline POT station 1647+87.99 of NMP SP-7543(205).

865

SP-7543(205)

**Amrep Southwest, Inc.
24-1-E**

All of that certain tract of land lying and being situate within Section 7, Township 13 North, Range 2 East, Sandoval County, State of New Mexico and being all of Lot 29, Block 55, Unit Twenty-Six Rio Rancho Estates, as said Lot is shown and designated on the Plat entitled "BLOCKS 52 THRU 73, MULTIPLE TRACTS "CC" AND "DD", UNIT TWENTY-SIX RIO RANCHO ESTATES" as filed for record in the office of the county clerk of Sandoval County, State of New Mexico on March 12, 1970 in Volume 2, Folio 23, and containing 25,137 square feet (0.5771 acre), more or less.

The northwest corner of the parcel herein described lies 94.72 feet to the right of, southerly and opposite survey centerline POT station 1647+87.99 of NMP SP-7543(205).

866

SP-7543(205)

**Amrep Southwest, Inc.
24-1-F**

All of that certain tract of land lying and being situate within Section 7, Township 13 North, Range 2 East, Sandoval County, State of New Mexico and being all of Lot 27, Block 55, Unit Twenty-Six Rio Rancho Estates, as said Lot is shown and designated on the Plat entitled "BLOCKS 52 THRU 73, MULTIPLE TRACTS "CC" AND "DD", UNIT TWENTY-SIX RIO RANCHO ESTATES" as filed for record in the office of the county clerk of Sandoval County, State of New Mexico on March 12, 1970 in Volume 2, Folio 23, and containing 23,289 square feet (0.5346 acre), more or less.

The southwest corner of the parcel herein described lies 302.47 feet to the right of, southerly and opposite survey centerline POT station 1649+08.20 of NMP SP-7543(205).

867

SP-7543(205)

**Amrep Southwest, Inc.
24-1-G**

All of that certain tract of land lying and being situate within Section 7, Township 13 North, Range 2 East, Sandoval County, State of New Mexico and being all of Lot 15, Block 55, Unit Twenty-Six Rio Rancho Estates, as said Lot is shown and designated on the Plat entitled "BLOCKS 52 THRU 73, MULTIPLE TRACTS "CC" AND "DD", UNIT TWENTY-SIX RIO RANCHO ESTATES" as filed for record in the office of the county clerk of Sandoval County, State of New Mexico on March 12, 1970 in Volume 2, Folio 23, and containing 24,025 square feet (0.5515 acre), more or less.

The northwest corner of the parcel herein described lies 121.66 feet to the left of, northerly and opposite survey centerline POT station 1651+40.01 of NMP SP-7543(205).

868

SP-7543(205)

**Amrep Southwest, Inc.
24-1-H**

All of that certain tract of land lying and being situate within Section 7, Township 13 North, Range 2 East, Sandoval County, State of New Mexico and being all of Lot 16, Block 55, Unit Twenty-Six Rio Rancho Estates, as said Lot is shown and designated on the Plat entitled "BLOCKS 52 THRU 73, MULTIPLE TRACTS "CC" AND "DD", UNIT TWENTY-SIX RIO RANCHO ESTATES" as filed for record in the office of the county clerk of Sandoval County, State of New Mexico on March 12, 1970 in Volume 2, Folio 23, and containing 24,245 square feet (0.5566 acre), more or less.

The northwest corner of the parcel herein described lies 210.16 feet to the right of, southerly and opposite survey centerline POT station 1651+75.56 of NMP SP-7543(205).

869

SP-7543(205)

**Amrep Southwest, Inc.
24-1-I**

All of that certain tract of land lying and being situate within Section 7, Township 13 North, Range 2 East, Sandoval County, State of New Mexico and being all of Lot 31, Block 54, Unit Twenty-Six Rio Rancho Estates, as said Lot is shown and designated on the Plat entitled "BLOCKS 52 THRU 73, MULTIPLE TRACTS "CC" AND "DD", UNIT TWENTY-SIX RIO RANCHO ESTATES" as filed for record in the office of the county clerk of Sandoval County, State of New Mexico on March 12, 1970 in Volume 2, Folio 23, and containing 24,648 square feet (0.5658 acre), more or less.

The northwest corner of the parcel herein described lies 227.60 feet to the left of, northerly and opposite survey centerline POT station 1653+53.81 of NMP SP-7543(205).

870

SP-7543(205)

**Amrep Southwest, Inc.
24-1-J**

All of that certain tract of land lying and being situate within Section 7, Township 13 North, Range 2 East, Sandoval County, State of New Mexico and being all of Lot 30, Block 54, Unit Twenty-Six Rio Rancho Estates, as said Lot is shown and designated on the Plat entitled "BLOCKS 52 THRU 73, MULTIPLE TRACTS "CC" AND "DD", UNIT TWENTY-SIX RIO RANCHO ESTATES" as filed for record in the office of the county clerk of Sandoval County, State of New Mexico on March 12, 1970 in Volume 2, Folio 23, and containing 24,752 square feet (0.5682 acre), more or less.

The northeast corner of the parcel herein described lies 222.47 feet to the left of, northerly and opposite survey centerline POT station 1656+43.81 of NMP SP-7543(205).

871

SP-7543(205)

**Amrep Southwest, Inc.
24-1-K**

All of that certain tract of land lying and being situate within Section 7, Township 13 North, Range 2 East, Sandoval County, State of New Mexico and being all of Lot 29, Block 54, Unit Twenty-Six Rio Rancho Estates, as said Lot is shown and designated on the Plat entitled "BLOCKS 52 THRU 73, MULTIPLE TRACTS "CC" AND "DD", UNIT TWENTY-SIX RIO RANCHO ESTATES" as filed for record in the office of the county clerk of Sandoval County, State of New Mexico on March 12, 1970 in Volume 2, Folio 23, and containing 24,558 square feet (0.5638 acre), more or less.

The southeast corner of the parcel herein described lies 68.67 feet to the left of, northerly and opposite survey centerline POT station 1657+03.34 of NMP SP-7543(205).

872

SP-7543(205)

**Amrep Southwest, Inc.
24-1-L**

All of that certain tract of land lying and being situate within Section 7, Township 13 North, Range 2 East, Sandoval County, State of New Mexico and being all of Lot 28, Block 54, Unit Twenty-Six Rio Rancho Estates, as said Lot is shown and designated on the Plat entitled "BLOCKS 52 THRU 73, MULTIPLE TRACTS "CC" AND "DD", UNIT TWENTY-SIX RIO RANCHO ESTATES" as filed for record in the office of the county clerk of Sandoval County, State of New Mexico on March 12, 1970 in Volume 2, Folio 23, and containing 24,683 square feet (0.5666 acre), more or less.

The northeast corner of the parcel herein described lies 68.67 feet to the left of, northerly and opposite survey centerline POT station 1657+03.34 of NMP SP-7543(205).

873

SP-7543(205)

**Amrep Southwest, Inc.
24-1-M**

All of that certain tract of land lying and being situate within Section 7, Township 13 North, Range 2 East, Sandoval County, State of New Mexico and being all of Lot 6, Block 54, Unit Twenty-Six Rio Rancho Estates, as said Lot is shown and designated on the Plat entitled "BLOCKS 52 THRU 73, MULTIPLE TRACTS "CC" AND "DD", UNIT TWENTY-SIX RIO RANCHO ESTATES" as filed for record in the office of the county clerk of Sandoval County, State of New Mexico on March 12, 1970 in Volume 2, Folio 23, and containing 25,624 square feet (0.5882 acre), more or less.

The northwest corner of the parcel herein described lies 201.23 feet to the left of, northerly and opposite survey centerline POT station 1656+51.33 of NMP SP-7543(205).

874

SP-7543(205)

**Amrep Southwest, Inc.
24-1-N**

All of that certain tract of land lying and being situate within Section 7, Township 13 North, Range 2 East, Sandoval County, State of New Mexico and being all of Lot 7, Block 54, Unit Twenty-Six Rio Rancho Estates, as said Lot is shown and designated on the Plat entitled "BLOCKS 52 THRU 73, MULTIPLE TRACTS "CC" AND "DD", UNIT TWENTY-SIX RIO RANCHO ESTATES" as filed for record in the office of the county clerk of Sandoval County, State of New Mexico on March 12, 1970 in Volume 2, Folio 23, and containing 25,613 square feet (0.5880 acre), more or less.

The northwest corner of the parcel herein described lies 102.54 feet to the left of, northerly and opposite survey centerline POT station 1656+86.29 of NMP SP-7543(205).

SP-7543(205)

**Amrep Southwest, Inc.
24-1-O**

All of that certain tract of land lying and being situate within Section 7, Township 13 North, Range 2 East, Sandoval County, State of New Mexico and being all of Lot 44, Block 47, Unit Twenty-Six Rio Rancho Estates, as said Lot is shown and designated on the Plat entitled "BLOCKS 52 THRU 73, MULTIPLE TRACTS "CC" AND "DD", UNIT TWENTY-SIX RIO RANCHO ESTATES" as filed for record in the office of the county clerk of Sandoval County, State of New Mexico on March 12, 1970 in Volume 2, Folio 23, and containing 21,787 square feet (0.5002 acre), more or less.

The southeast corner of the parcel herein described lies 191.39 feet to the left of, northerly and opposite survey centerline POT station 1663+68.70 of NMP SP-7543(205).

876

SP-7543(205)

**Amrep Southwest, Inc.
24-1-P**

All of that certain tract of land lying and being situate within Section 7, Township 13 North, Range 2 East, Sandoval County, State of New Mexico and being all of Lot 43, Block 47, Unit Twenty-Six Rio Rancho Estates, as said Lot is shown and designated on the Plat entitled "BLOCKS 52 THRU 73, MULTIPLE TRACTS "CC" AND "DD", UNIT TWENTY-SIX RIO RANCHO ESTATES" as filed for record in the office of the county clerk of Sandoval County, State of New Mexico on March 12, 1970 in Volume 2, Folio 23, and containing 21,785 square feet (0.5001 acre), more or less.

The northeast corner of the parcel herein described lies 191.39 feet to the left of, northerly and opposite survey centerline POT station 1663+68.70 of NMP SP-7543(205).

877

SP-7543(205)

**Amrep Southwest, Inc.
24-1-Q**

All of that certain tract of land lying and being situate within Section 7, Township 13 North, Range 2 East, Sandoval County, State of New Mexico and being all of Lot 6, Block 47, Unit Twenty-Six Rio Rancho Estates, as said Lot is shown and designated on the Plat entitled "BLOCKS 52 THRU 73, MULTIPLE TRACTS "CC" AND "DD", UNIT TWENTY-SIX RIO RANCHO ESTATES" as filed for record in the office of the county clerk of Sandoval County, State of New Mexico on March 12, 1970 in Volume 2, Folio 23, and containing 21,784 square feet (0.5001 acre), more or less.

The northwest corner of the parcel herein described lies 191.39 feet to the left of, northerly and opposite survey centerline POT station 1663+68.70 of NMP SP-7543(205).

SP-7543(205)

Amrep Southwest, Inc.
25-9

All of that certain tract of land lying and being situate within Section 8, Township 13 North, Range 2 East, Sandoval County, State of New Mexico and being all of Lot 14, Block 46, Unit Twenty-Six Rio Rancho Estates, as said Lot is shown and designated on the Plat entitled "BLOCKS 36 THRU 51, TRACTS "C" & "D", COMMERCIAL TRACTS "E" & "F" MULTIPLE TRACTS "AA" & "BB" UNIT TWENTY-SIX RIO RANCHO ESTATES", filed in the office of the county clerk of Sandoval County, State of New Mexico on March 12, 1970 in Volume 2, Folio 22, and containing 21,787 square feet (0.5002 acre), more or less.

The northeast corner of the parcel herein described lies 140.67 feet to the left of, northerly and opposite construction centerline POT station 1673+99.35 of NMP SP-7543(205).

879

SP-7543(205)

**Amrep Southwest, Inc.
25-9-A**

All of that certain tract of land lying and being situate within Section 8, Township 13 North, Range 2 East, Sandoval County, State of New Mexico and being all of Lot 16, Block 46, Unit Twenty-Six Rio Rancho Estates, as said Lot is shown and designated on the Plat entitled "BLOCKS 36 THRU 51, TRACTS "C" & "D", COMMERCIAL TRACTS "E" & "F" MULTIPLE TRACTS "AA" & "BB" UNIT TWENTY-SIX RIO RANCHO ESTATES", filed in the office of the county clerk of Sandoval County, State of New Mexico on March 12, 1970 in Volume 2, Folio 22, and containing 21,787 square feet (0.5002 acre), more or less.

The southwest corner of the parcel herein described lies 203.46 feet to the right of, southerly and opposite construction centerline POT station 1672+83.85 of NMP SP-7543(205).

SP-7543(205)

**Amrep Southwest, Inc.
25-9-B**

All of that certain tract of land lying and being situate within Section 8, Township 13 North, Range 2 East, Sandoval County, State of New Mexico and being all of Lot 18, Block 46, Unit Twenty-Six Rio Rancho Estates, as said Lot is shown and designated on the Plat entitled "BLOCKS 36 THRU 51, TRACTS "C" & "D", COMMERCIAL TRACTS "E" & "F" MULTIPLE TRACTS "AA" & "BB" UNIT TWENTY-SIX RIO RANCHO ESTATES", filed in the office of the county clerk of Sandoval County, State of New Mexico on March 12, 1970 in Volume 2, Folio 22, and containing 21,787 square feet (0.5002 acre), more or less.

The southwest corner of the parcel herein described lies 342.00 feet to the right of, southerly and opposite construction centerline POT station 1673+63.98 of NMP SP-7543(205).

SP-7543(205)

**Amrep Southwest, Inc.
25-9-C**

All of that certain tract of land lying and being situate within Section 8, Township 13 North, Range 2 East, Sandoval County, State of New Mexico and being all of Lot 30, Block 45, Unit Twenty-Six Rio Rancho Estates, as said Lot is shown and designated on the Plat entitled "BLOCKS 36 THRU 51, TRACTS "C" & "D", COMMERCIAL TRACTS "E" & "F" MULTIPLE TRACTS "AA" & "BB" UNIT TWENTY-SIX RIO RANCHO ESTATES", filed in the office of the county clerk of Sandoval County, State of New Mexico on March 12, 1970 in Volume 2, Folio 22, and containing 21,785 square feet (0.5001 acre), more or less.

The northwest corner of the parcel herein described lies 180.64 feet to the right of, southerly and opposite construction centerline POT station 1676+42.88 of NMP SP-7543(205).

SP-7543(205)

**Amrep Southwest, Inc.
25-9-D**

All of that certain tract of land lying and being situate within Section 8, Township 13 North, Range 2 East, Sandoval County, State of New Mexico and being all of Lot 29, Block 45, Unit Twenty-Six Rio Rancho Estates, as said Lot is shown and designated on the Plat entitled "BLOCKS 36 THRU 51, TRACTS "C" & "D", COMMERCIAL TRACTS "E" & "F" MULTIPLE TRACTS "AA" & "BB" UNIT TWENTY-SIX RIO RANCHO ESTATES", filed in the office of the county clerk of Sandoval County, State of New Mexico on March 12, 1970 in Volume 2, Folio 22, and containing 21,786 square feet (0.5001 acre), more or less.

The southwest corner of the parcel herein described lies 319.18 feet to the right of, southerly and opposite construction centerline POT station 1677+23.01 of NMP SP-7543(205).

SP-7543(205)

**Amrep Southwest, Inc.
25-9-E**

All of that certain tract of land lying and being situate within Section 8, Township 13 North, Range 2 East, Sandoval County, State of New Mexico and being all of Lot 9, Block 45, Unit Twenty-Six Rio Rancho Estates, as said Lot is shown and designated on the Plat entitled "BLOCKS 36 THRU 51, TRACTS "C" & "D", COMMERCIAL TRACTS "E" & "F" MULTIPLE TRACTS "AA" & "BB" UNIT TWENTY-SIX RIO RANCHO ESTATES", filed in the office of the county clerk of Sandoval County, State of New Mexico on March 12, 1970 in Volume 2, Folio 22, and containing 21,788 square feet (0.5002 acre), more or less.

The northwest corner of the parcel herein described lies 182.79 feet to the right of, southerly and opposite construction centerline POT station 1679+58.64 of NMP SP-7543(205).

SP-7543(205)

**Amrep Southwest, Inc.
25-9-F**

All of that certain tract of land lying and being situate within Section 8, Township 13 North, Range 2 East, Sandoval County, State of New Mexico and being all of Lot 10, Block 45, Unit Twenty-Six Rio Rancho Estates, as said Lot is shown and designated on the Plat entitled "BLOCKS 36 THRU 51, TRACTS "C" & "D", COMMERCIAL TRACTS "E" & "F" MULTIPLE TRACTS "AA" & "BB" UNIT TWENTY-SIX RIO RANCHO ESTATES", filed in the office of the county clerk of Sandoval County, State of New Mexico on March 12, 1970 in Volume 2, Folio 22, and containing 21,788 square feet (0.5002 acre), more or less.

The southwest corner of the parcel herein described lies 321.31 feet to the right of, southerly and opposite construction centerline POT station 1680+38.78 of NMP SP-7543(205).

SP-7543(205)

**Amrep Southwest, Inc.
25-9-G**

All of that certain tract of land lying and being situate within Section 8, Township 13 North, Range 2 East, Sandoval County, State of New Mexico and being all of Lot 99, Block 44, Unit Twenty-Six Rio Rancho Estates, as said Lot is shown and designated on the Plat entitled "BLOCKS 36 THRU 51, TRACTS "C" & "D", COMMERCIAL TRACTS "E" & "F" MULTIPLE TRACTS "AA" & "BB" UNIT TWENTY-SIX RIO RANCHO ESTATES", filed in the office of the county clerk of Sandoval County, State of New Mexico on March 12, 1970 in Volume 2, Folio 22, and containing 21,644 square feet (0.4969 acre), more or less.

The southeast corner of the parcel herein described lies 158.50 feet to the right of, southerly and opposite construction centerline POT station 1684+11.42 of NMP SP-7543(205).

SP-7543(205)

**Amrep Southwest, Inc.
25-9-H**

All of that certain tract of land lying and being situate within Section 8, Township 13 North, Range 2 East, Sandoval County, State of New Mexico and being all of Lot 100, Block 44, Unit Twenty-Six Rio Rancho Estates, as said Lot is shown and designated on the Plat entitled "BLOCKS 36 THRU 51, TRACTS "C" & "D", COMMERCIAL TRACTS "E" & "F" MULTIPLE TRACTS "AA" & "BB" UNIT TWENTY-SIX RIO RANCHO ESTATES", filed in the office of the county clerk of Sandoval County, State of New Mexico on March 12, 1970 in Volume 2, Folio 22, and containing 21,777 square feet (0.4999 acre), more or less.

The southwest corner of the parcel herein described lies 158.50 feet to the right of, southerly and opposite construction centerline POT station 1684+11.42 of NMP SP-7543(205).

SP-7543(205)

Amrep Southwest, Inc.

25-9-I

All of that certain tract of land lying and being situate within Section 8, Township 13 North, Range 2 East, Sandoval County, State of New Mexico and being all of Lot 107, Block 44, Unit Twenty-Six Rio Rancho Estates, as said Lot is shown and designated on the Plat entitled "BLOCKS 36 THRU 51, TRACTS "C" & "D", COMMERCIAL TRACTS "E" & "F" MULTIPLE TRACTS "AA" & "BB" UNIT TWENTY-SIX RIO RANCHO ESTATES", filed in the office of the county clerk of Sandoval County, State of New Mexico on March 12, 1970 in Volume 2, Folio 22, and containing 53,034 square feet (1.2175 acre), more or less.

The northeast corner of the parcel herein described lies 470.32 feet to the left of, northerly and opposite construction centerline POT station 1689+54.95 of NMP SP-7543(205).

SP-7543(205)

**Amrep Southwest, Inc.
25-9-J**

All of that certain tract of land lying and being situate within Section 8, Township 13 North, Range 2 East, Sandoval County, State of New Mexico and being all of Lot 108, Block 44, Unit Twenty-Six Rio Rancho Estates, as said Lot is shown and designated on the Plat entitled "BLOCKS 36 THRU 51, TRACTS "C" & "D", COMMERCIAL TRACTS "E" & "F" MULTIPLE TRACTS "AA" & "BB" UNIT TWENTY-SIX RIO RANCHO ESTATES", filed in the office of the county clerk of Sandoval County, State of New Mexico on March 12, 1970 in Volume 2, Folio 22, and containing 65,876 square feet (1.5123 acre), more or less.

The southwest corner of the parcel herein described lies 158.19 feet to the right of, southerly and opposite construction centerline POT station 1690+55.95 of NMP SP-7543(205).

SP-7543(205)

**Amrep Southwest, Inc.
25-9-K**

All of that certain tract of land lying and being situate within Section 8, Township 13 North, Range 2 East, Sandoval County, State of New Mexico and being all of Lot 126, Block 44, Unit Twenty-Six Rio Rancho Estates, as said Lot is shown and designated on the Plat entitled "BLOCKS 36 THRU 51, TRACTS "C" & "D", COMMERCIAL TRACTS "E" & "F" MULTIPLE TRACTS "AA" & "BB" UNIT TWENTY-SIX RIO RANCHO ESTATES", filed in the office of the county clerk of Sandoval County, State of New Mexico on March 12, 1970 in Volume 2, Folio 22, and containing 21,761 square feet (0.4996 acre), more or less.

The southeast corner of the parcel herein described lies 313.40 feet to the right of, southerly and opposite construction centerline POT station 1693+31.02 of NMP SP-7543(205).

SP-7543(205)

**Amrep Southwest, Inc.
26-1**

All of that certain tract of land lying and being situate within Section 8, Township 13 North, Range 2 East, Sandoval County, State of New Mexico and being all of Lot 130, Block 44, Unit Twenty-Six Rio Rancho Estates, as said Lot is shown and designated on the Plat entitled "BLOCKS 36 THRU 51, TRACTS "C" & "D", COMMERCIAL TRACTS "E" & "F" MULTIPLE TRACTS "AA" & "BB" UNIT TWENTY-SIX RIO RANCHO ESTATES", filed in the office of the county clerk of Sandoval County, State of New Mexico on March 12, 1970 in Volume 2, Folio 22, and containing 31,933 square feet (0.7331 acre), more or less.

The northwest corner of the parcel herein described lies 176.82 feet to the left of, northerly and opposite construction centerline POT station 1693+24.57 of NMP SP-7543(205).

SP-7543(205)

**Amrep Southwest, Inc.
26-1-A**

All of that certain tract of land lying and being situate within Section 8, Township 13 North, Range 2 East, Sandoval County, State of New Mexico and being all of Lot 131, Block 44, Unit Twenty-Six Rio Rancho Estates, as said Lot is shown and designated on the Plat entitled "BLOCKS 36 THRU 51, TRACTS "C" & "D", COMMERCIAL TRACTS "E" & "F" MULTIPLE TRACTS "AA" & "BB" UNIT TWENTY-SIX RIO RANCHO ESTATES", filed in the office of the county clerk of Sandoval County, State of New Mexico on March 12, 1970 in Volume 2, Folio 22, and containing 26,524 square feet (0.6089 acre), more or less.

The northwest corner of the parcel herein described lies 167.59 feet to the left of, northerly and opposite construction centerline POT station 1694+22.37 of NMP SP-7543(205).

SP-7543(205)

**Amrep Southwest, Inc.
26-1-B**

All of that certain tract of land lying and being situate within Section 8, Township 13 North, Range 2 East, Sandoval County, State of New Mexico and being all of Lot 132, Block 44, Unit Twenty-Six Rio Rancho Estates, as said Lot is shown and designated on the Plat entitled "BLOCKS 36 THRU 51, TRACTS "C" & "D", COMMERCIAL TRACTS "E" & "F" MULTIPLE TRACTS "AA" & "BB" UNIT TWENTY-SIX RIO RANCHO ESTATES", filed in the office of the county clerk of Sandoval County, State of New Mexico on March 12, 1970 in Volume 2, Folio 22, and containing 23,291 square feet (0.5374 acre), more or less.

The northwest corner of the parcel herein described lies 162.04 feet to the left of, northerly and opposite construction centerline POT station 1694+81.25 of NMP SP-7543(205).

SP-7543(205)

**Amrep Southwest, Inc.
31-2**

All of that certain tract of land lying and being situate within Section 7, Township 13 North, Range 3 East, Sandoval County, State of New Mexico and being all of Lot 45, Block 160, Unit Twenty-Five Rio Rancho Estates, as said Lot is shown and designated on the Plat entitled "BLOCKS 151 THRU 160, A PORTION OF BLOCK 142, UNIT TWENTY-FIVE RIO RANCHO ESTATES", filed in the office of the county clerk of Sandoval County, State of New Mexico on March 5, 1971 in Volume 2, Folio 54, and containing 24,220 square feet (0.5560 acre), more or less.

The northwest corner of the parcel herein described lies 29.45 feet to the right of, southerly and opposite construction centerline POT station 1949+95.31 of NMP SP-7543(205).

SP-7543(205)

**Amrep Southwest, Inc.
31-2-A**

All of that certain tract of land lying and being situate within Section 7, Township 13 North, Range 3 East, Sandoval County, State of New Mexico and being all of Lot 46, Block 160, Unit Twenty-Five Rio Rancho Estates, as said Lot is shown and designated on the Plat entitled "BLOCKS 151 THRU 160, A PORTION OF BLOCK 142, UNIT TWENTY-FIVE RIO RANCHO ESTATES", filed in the office of the county clerk of Sandoval County, State of New Mexico on March 5, 1971 in Volume 2, Folio 54, and containing 24,042 square feet (0.5519 acre), more or less.

The northwest corner of the parcel herein described lies 39.06 feet to the left of, northerly and opposite construction centerline POT station 1950+36.71 of NMP SP-7543(205).

SP-7543(205)

**Amrep Southwest, Inc.
31-2-B**

All of that certain tract of land lying and being situate within Section 7, Township 13 North, Range 3 East, Sandoval County, State of New Mexico and being all of Lot 47, Block 160, Unit Twenty-Five Rio Rancho Estates, as said Lot is shown and designated on the Plat entitled "BLOCKS 151 THRU 160, A PORTION OF BLOCK 142, UNIT TWENTY-FIVE RIO RANCHO ESTATES", filed in the office of the county clerk of Sandoval County, State of New Mexico on March 5, 1971 in Volume 2, Folio 54, and containing 24,761 square feet (0.5684 acre), more or less.

The northwest corner of the parcel herein described lies 110.16 feet to the left of, northerly and opposite construction centerline POT station 1950+79.66 of NMP SP-7543(205).

SP-7543(205)

**Amrep Southwest, Inc.
31-2-C**

All of that certain tract of land lying and being situate within Section 7, Township 13 North, Range 3 East, Sandoval County, State of New Mexico and being all of Lot 2, Block 153, Unit Twenty-Five Rio Rancho Estates, as said Lot is shown and designated on the Plat entitled "BLOCKS 151 THRU 160, A PORTION OF BLOCK 142, UNIT TWENTY-FIVE RIO RANCHO ESTATES", filed in the office of the county clerk of Sandoval County, State of New Mexico on March 5, 1971 in Volume 2, Folio 54, and containing 32,696 square feet (0.7506 acre), more or less.

The southwest corner of the parcel herein described lies 254.68 feet to the right of, southerly and opposite construction centerline POT station 1953+99.19 of NMP SP-7543(205).

SP-7543(205)

**Amrep Southwest, Inc.
31-2-D**

All of that certain tract of land lying and being situate within Section 7, Township 13 North, Range 3 East, Sandoval County, State of New Mexico and being all of Lot 72, Block 160, Unit Twenty-Five Rio Rancho Estates, as said Lot is shown and designated on the Plat entitled "BLOCKS 151 THRU 160, A PORTION OF BLOCK 142, UNIT TWENTY-FIVE RIO RANCHO ESTATES", filed in the office of the county clerk of Sandoval County, State of New Mexico on March 5, 1971 in Volume 2, Folio 54, and containing 21,784 square feet (0.5001 acre), more or less.

The northwest corner of the parcel herein described lies 130.02 feet to the left of, northerly and opposite construction centerline POC station 1958+73.06 of NMP SP-7543(205).

SP-7543(205)

**Amrep Southwest, Inc.
31-2-E**

All of that certain tract of land lying and being situate within Section 7, Township 13 North, Range 3 East, Sandoval County, State of New Mexico and being all of Lot 3, Block 153, Unit Twenty-Five Rio Rancho Estates, as said Lot is shown and designated on the Plat entitled "BLOCKS 151 THRU 160, A PORTION OF BLOCK 142, UNIT TWENTY-FIVE RIO RANCHO ESTATES", filed in the office of the county clerk of Sandoval County, State of New Mexico on March 5, 1971 in Volume 2, Folio 54, and containing 32,677 square feet (0.7502 acre), more or less.

The southwest corner of the parcel herein described lies 320.90 feet to the right of, southerly and opposite construction centerline POC station 1954+92.28 of NMP SP-7543(205).

SP-7543(205)

**Amrep Southwest, Inc.
31-2-F**

All of that certain tract of land lying and being situate within Section 7, Township 13 North, Range 3 East, Sandoval County, State of New Mexico and being all of Lot 71, Block 160, Unit Twenty-Five Rio Rancho Estates, as said Lot is shown and designated on the Plat entitled "BLOCKS 151 THRU 160, A PORTION OF BLOCK 142, UNIT TWENTY-FIVE RIO RANCHO ESTATES", filed in the office of the county clerk of Sandoval County, State of New Mexico on March 5, 1971 in Volume 2, Folio 54, and containing 21,785 square feet (0.5001 acre), more or less.

The northwest corner of the parcel herein described lies 279.70 feet to the left of, northerly and opposite construction centerline POC station 1961+27.99 of NMP SP-7543(205).

SP-7543(205)

**Amrep Southwest, Inc.
31-2-G**

All of that certain tract of land lying and being situate within Section 7, Township 13 North, Range 3 East, Sandoval County, State of New Mexico and being all of Lot 61, Block 154, Unit Twenty-Five Rio Rancho Estates, as said Lot is shown and designated on the Plat entitled "BLOCKS 151 THRU 160, A PORTION OF BLOCK 142, UNIT TWENTY-FIVE RIO RANCHO ESTATES", filed in the office of the county clerk of Sandoval County, State of New Mexico on March 5, 1971 in Volume 2, Folio 54, and containing 21,777 square feet (0.4999 acre), more or less.

The northwest corner of the parcel herein described lies 262.32 feet to the left of, northerly and opposite construction centerline POC station 1966+16.76 of NMP SP-7543(205).

SP-7543(205)

**Amrep Southwest, Inc.
32-1**

All of that certain tract of land lying and being situate within Section 7, Township 13 North, Range 3 East, Sandoval County, State of New Mexico and being all of Lot 56, Block 154, Unit Twenty-Five Rio Rancho Estates, as said Lot is shown and designated on the Plat entitled "BLOCKS 151 THRU 160, A PORTION OF BLOCK 142, UNIT TWENTY-FIVE RIO RANCHO ESTATES", filed in the office of the county clerk of Sandoval County, State of New Mexico on March 5, 1971 in Volume 2, Folio 54, and containing 21,649 square feet (0.4970 acre), more or less.

The northwest corner of the parcel herein described lies 162.55 feet to the left of, northerly and opposite construction centerline POT station 1970+44.69 of NMP SP-7543(205).

SP-7543(205)

**Amrep Southwest, Inc.
32-1-A**

All of that certain tract of land lying and being situate within Section 7, Township 13 North, Range 3 East, Sandoval County, State of New Mexico and being all of Lot 50, Block 154, Unit Twenty-Five Rio Rancho Estates, as said Lot is shown and designated on the Plat entitled "BLOCKS 151 THRU 160, A PORTION OF BLOCK 142, UNIT TWENTY-FIVE RIO RANCHO ESTATES", filed in the office of the county clerk of Sandoval County, State of New Mexico on March 5, 1971 in Volume 2, Folio 54, and containing 24,389 square feet (0.5599 acre), more or less.

The northwest corner of the parcel herein described lies 342.60 feet to the left of, northerly and opposite construction centerline POT station 1973+11.95 of NMP SP-7543(205).

SP-7543(205)

**Amrep Southwest, Inc.
32-1-B**

All of that certain tract of land lying and being situate within Section 7, Township 13 North, Range 3 East, Sandoval County, State of New Mexico and being all of Lot 131, Block 142, Unit Twenty-Five Rio Rancho Estates, as said Lot is shown and designated on the Plat entitled "BLOCKS 151 THRU 160, A PORTION OF BLOCK 142, UNIT TWENTY-FIVE RIO RANCHO ESTATES", filed in the office of the county clerk of Sandoval County, State of New Mexico on March 5, 1971 in Volume 2, Folio 54, and containing 21,781 square feet (0.5000 acre), more or less.

The southwest corner of the parcel herein described lies 180.14 feet to the right of, southerly and opposite construction centerline POT station 1972+55.93 of NMP SP-7543(205).

SP-7543(205)

**Amrep Southwest, Inc.
32-1-C**

All of that certain tract of land lying and being situate within Section 7, Township 13 North, Range 3 East, Sandoval County, State of New Mexico and being all of Lot 19, Block 142, Unit Twenty-Five Rio Rancho Estates, as said Lot is shown and designated on the Plat entitled "BLOCKS 151 THRU 160, A PORTION OF BLOCK 142, UNIT TWENTY-FIVE RIO RANCHO ESTATES", filed in the office of the county clerk of Sandoval County, State of New Mexico on March 5, 1971 in Volume 2, Folio 54, and containing 29,151 square feet (0.6692 acre), more or less.

The northwest corner of the parcel herein described lies 161.14 feet to the right of, southerly and opposite construction centerline POT station 1972+83.13 of NMP SP-7543(205).

SP-7543(205)

**Amrep Southwest, Inc.
32-1-D**

All of that certain tract of land lying and being situate within Section 7, Township 13 North, Range 3 East, Sandoval County, State of New Mexico and being all of Lot 134, Block 142, Unit Twenty-Five Rio Rancho Estates, as said Lot is shown and designated on the Plat entitled "BLOCKS 151 THRU 160, A PORTION OF BLOCK 142, UNIT TWENTY-FIVE RIO RANCHO ESTATES", filed in the office of the county clerk of Sandoval County, State of New Mexico on March 5, 1971 in Volume 2, Folio 54, and containing 21,782 square feet (0.5000 acre), more or less.

The northwest corner of the parcel herein described lies 168.25 feet to the left of, northerly and opposite construction centerline POT station 1973+87.07 of NMP SP-7543(205).

SP-7543(205)

**Amrep Southwest, Inc.
32-1-E**

All of that certain tract of land lying and being situate within Section 7, Township 13 North, Range 3 East, Sandoval County, State of New Mexico and being all of Lot 135, Block 142, Unit Twenty-Five Rio Rancho Estates, as said Lot is shown and designated on the Plat entitled "BLOCKS 151 THRU 160, A PORTION OF BLOCK 142, UNIT TWENTY-FIVE RIO RANCHO ESTATES", filed in the office of the county clerk of Sandoval County, State of New Mexico on March 5, 1971 in Volume 2, Folio 54, and containing 21,780 square feet (0.5000 acre), more or less.

The northwest corner of the parcel herein described lies 170.64 feet to the left of, northerly and opposite construction centerline POT station 1974+67.03 of NMP SP-7543(205).

SP-7543(205)

**Amrep Southwest, Inc.
32-1-F**

All of that certain tract of land lying and being situate within Section 7, Township 13 North, Range 3 East, Sandoval County, State of New Mexico and being all of Lot 17, Block 142, Unit Twenty-Five Rio Rancho Estates, as said Lot is shown and designated on the Plat entitled "BLOCKS 151 THRU 160, A PORTION OF BLOCK 142, UNIT TWENTY-FIVE RIO RANCHO ESTATES", filed in the office of the county clerk of Sandoval County, State of New Mexico on March 5, 1971 in Volume 2, Folio 54, and containing 27,222 square feet (0.6249 acre), more or less.

The southwest corner of the parcel herein described lies 409.73 feet to the right of, southerly and opposite construction centerline POT station 1975+50.21 of NMP SP-7543(205).

SP-7543(205)

**Amrep Southwest, Inc.
32-1-G**

All of that certain tract of land lying and being situate within Section 7, Township 13 North, Range 3 East, Sandoval County, State of New Mexico and being all of Lot 136, Block 142, Unit Twenty-Five Rio Rancho Estates, as said Lot is shown and designated on the Plat entitled "BLOCKS 151 THRU 160, A PORTION OF BLOCK 142, UNIT TWENTY-FIVE RIO RANCHO ESTATES", filed in the office of the county clerk of Sandoval County, State of New Mexico on March 5, 1971 in Volume 2, Folio 54, and containing 21,780 square feet (0.5000 acre), more or less.

The northwest corner of the parcel herein described lies 173.03 feet to the left of, northerly and opposite construction centerline POT station 1975+46.99 of NMP SP-7543(205).

SP-7543(205)

**Amrep Southwest, Inc.
32-1-H**

All of that certain tract of land lying and being situate within Section 7, Township 13 North, Range 3 East, Sandoval County, State of New Mexico and being all of Lot 16, Block 142, Unit Twenty-Five Rio Rancho Estates, as said Lot is shown and designated on the Plat entitled "BLOCKS 151 THRU 160, A PORTION OF BLOCK 142, UNIT TWENTY-FIVE RIO RANCHO ESTATES", filed in the office of the county clerk of Sandoval County, State of New Mexico on March 5, 1971 in Volume 2, Folio 54, and containing 25,603 square feet (0.5878 acre), more or less.

The southwest corner of the parcel herein described lies 391.45 feet to the right of, southerly and opposite construction centerline POT station 1976+28.08 of NMP SP-7543(205).

SP-7543(205)

**Amrep Southwest, Inc.
32-1-I**

All of that certain tract of land lying and being situate within Section 7, Township 13 North, Range 3 East, Sandoval County, State of New Mexico and being all of Lot 14, Block 142, Unit Twenty-Five Rio Rancho Estates, as said Lot is shown and designated on the Plat entitled "BLOCKS 151 THRU 160, A PORTION OF BLOCK 142, UNIT TWENTY-FIVE RIO RANCHO ESTATES", filed in the office of the county clerk of Sandoval County, State of New Mexico on March 5, 1971 in Volume 2, Folio 54, and containing 29,028 square feet (0.6664 acre), more or less.

The southwest corner of the parcel herein described lies 367.62 feet to the right of, southerly and opposite construction centerline POT station 1977+86.21 of NMP SP-7543(205).

SP-7543(205)

**Amrep Southwest, Inc.
32-1-J**

All of that certain tract of land lying and being situate within Section 7, Township 13 North, Range 3 East, Sandoval County, State of New Mexico and being all of Lot 9, Block 142, Unit Twenty-Five Rio Rancho Estates, as said Lot is shown and designated on the Plat entitled "BLOCKS 151 THRU 160, A PORTION OF BLOCK 142, UNIT TWENTY-FIVE RIO RANCHO ESTATES", filed in the office of the county clerk of Sandoval County, State of New Mexico on March 5, 1971 in Volume 2, Folio 54, and containing 21,790 square feet (0.5002 acre), more or less.

The southwest corner of the parcel herein described lies 351.89 feet to the right of, southerly and opposite construction centerline POT station 1982+03.28 of NMP SP-7543(205).

912

SP-7543(205)

**Amrep Southwest, Inc.
32-1-K**

All of that certain tract of land lying and being situate within Section 7, Township 13 North, Range 3 East, Sandoval County, State of New Mexico and being all of Lot 8, Block 142, Unit Twenty-Five Rio Rancho Estates, as said Lot is shown and designated on the Plat entitled "BLOCKS 151 THRU 160, A PORTION OF BLOCK 142, UNIT TWENTY-FIVE RIO RANCHO ESTATES", filed in the office of the county clerk of Sandoval County, State of New Mexico on March 5, 1971 in Volume 2, Folio 54, and containing 21,790 square feet (0.5002 acre), more or less.

The southwest corner of the parcel herein described lies 349.49 feet to the right of, southerly and opposite construction centerline POT station 1982+83.30 of NMP SP-7543(205).

SP-7543(205)

Amrep Southwest, Inc.

32-1-L

All of that certain tract of land lying and being situate within Section 7, Township 13 North, Range 3 East, Sandoval County, State of New Mexico and being all of Lot 7, Block 142, Unit Twenty-Five Rio Rancho Estates, as said Lot is shown and designated on the Plat entitled "BLOCKS 151 THRU 160, A PORTION OF BLOCK 142, UNIT TWENTY-FIVE RIO RANCHO ESTATES", filed in the office of the county clerk of Sandoval County, State of New Mexico on March 5, 1971 in Volume 2, Folio 54, and containing 21,790 square feet (0.5002 acre), more or less.

The southwest corner of the parcel herein described lies 347.08 feet to the right of, southerly and opposite construction centerline POT station 1983+63.33 of NMP SP-7543(205).

SP-7543(205)

**Amrep Southwest, Inc.
32-1-M**

All of that certain tract of land lying and being situate within Section 7, Township 13 North, Range 3 East, Sandoval County, State of New Mexico and being all of Lot 6, Block 142, Unit Twenty-Five Rio Rancho Estates, as said Lot is shown and designated on the Plat entitled "BLOCKS 151 THRU 160, A PORTION OF BLOCK 142, UNIT TWENTY-FIVE RIO RANCHO ESTATES", filed in the office of the county clerk of Sandoval County, State of New Mexico on March 5, 1971 in Volume 2, Folio 54, and containing 21,789 square feet (0.5002 acre), more or less.

The southwest corner of the parcel herein described lies 344.67 feet to the right of, southerly and opposite construction centerline POT station 1984+43.35 of NMP SP-7543(205).

SP-7543(205)

**Amrep Southwest, Inc.
32-1-N**

All of that certain tract of land lying and being situate within Section 7, Township 13 North, Range 3 East, Sandoval County, State of New Mexico and being all of Lot 148, Block 142, Unit Twenty-Five Rio Rancho Estates, as said Lot is shown and designated on the Plat entitled "BLOCKS 151 THRU 160, A PORTION OF BLOCK 142, UNIT TWENTY-FIVE RIO RANCHO ESTATES", filed in the office of the county clerk of Sandoval County, State of New Mexico on March 5, 1971 in Volume 2, Folio 54, and containing 21,769 square feet (0.4998 acre), more or less.

The northwest corner of the parcel herein described lies 201.70 feet to the left of, northerly and opposite construction centerline POT station 1985+06.60 of NMP SP-7543(205).

SP-7543(205)

**Amrep Southwest, Inc.
32-1-O**

All of that certain tract of land lying and being situate within Section 7, Township 13 North, Range 3 East, Sandoval County, State of New Mexico and being all of Lot 150, Block 142, Unit Twenty-Five Rio Rancho Estates, as said Lot is shown and designated on the Plat entitled "BLOCKS 151 THRU 160, A PORTION OF BLOCK 142, UNIT TWENTY-FIVE RIO RANCHO ESTATES", filed in the office of the county clerk of Sandoval County, State of New Mexico on March 5, 1971 in Volume 2, Folio 54, and containing 37,856 square feet (0.8690 acre), more or less.

The northwest corner of the parcel herein described lies 216.48 feet to the left of, northerly and opposite construction centerline POT station 1986+70.74 of NMP SP-7543(205).

SP-7543(205)

**Amrep Southwest, Inc.
32-1-P**

All of that certain tract of land lying and being situate within Section 7, Township 13 North, Range 3 East, Sandoval County, State of New Mexico and being all of Lot 1, Block 142, Unit Twenty-Five Rio Rancho Estates, as said Lot is shown and designated on the Plat entitled "BLOCKS 151 THRU 160, A PORTION OF BLOCK 142, UNIT TWENTY-FIVE RIO RANCHO ESTATES", filed in the office of the county clerk of Sandoval County, State of New Mexico on March 5, 1971 in Volume 2, Folio 54, and containing 40,309 square feet (0.9254 acre), more or less.

The southwest corner of the parcel herein described lies 332.64 feet to the right of, southerly and opposite construction centerline POT station 1988+43.46 of NMP SP-7543(205).

SP-7543(205)

**Amrep Southwest, Inc.
32-1-Q**

All of that certain tract of land lying and being situate within Section 7, Township 13 North, Range 3 East, Sandoval County, State of New Mexico and being all of Lot 152, Block 142, Unit Twenty-Five Rio Rancho Estates, as said Lot is shown and designated on the Plat entitled "BLOCKS 151 THRU 160, A PORTION OF BLOCK 142, UNIT TWENTY-FIVE RIO RANCHO ESTATES", filed in the office of the county clerk of Sandoval County, State of New Mexico on March 5, 1971 in Volume 2, Folio 54, and containing 34,839 square feet (0.7998 acre), more or less.

The northwest corner of the parcel herein described lies 357.74 feet to the left of, northerly and opposite construction centerline POT station 1988+58.02 of NMP SP-7543(205).